

**Table of Contents**

- A01 - Table of Contents
- A02 - Framing North - Dimensions
- A03 - Framing North - Details
- A04 - Framing East - Dimensions I
- A05 - Framing East - Dimensions II
- A06 - Framing East - Details
- A07 - Framing South - Dimensions
- A08 - Framing South - Details
- A09 - Framing West - Dimensions I
- A10 - Framing West - Dimensions II
- A11 - Framing West - Details
- A12 - Framing Roof - Dimensions
- A13 - Framing Roof - Details
- A14 - Framing Lofts - Dimensions
- A15 - Framing Lofts - Details
- A16 - Framing Divider Walls
- A17 - West POV
- A18 - East POV
- D01-D05 - Framing Details I - V

**Note: ZIP panels do not require housewrap unless siding requires it. LP SmartSide requires drainable housewrap to be installed.**

**Note: All framing plan sheets shown from exterior view**

**For wall/roof sheathing, subfloor, and fastener schedule, see Details #7 & #9**



Backcountry Tiny Homes, LLC  
26 Owens Court  
Suite 6  
Hampstead, NH 03841

**Table of Contents**

Model Type: Custom

Designer Name: Tina  
Client Name(s): Peggy  
Project Number: BTH0095-PL  
Draft: Framing Plans  
Date: June 3, 2021

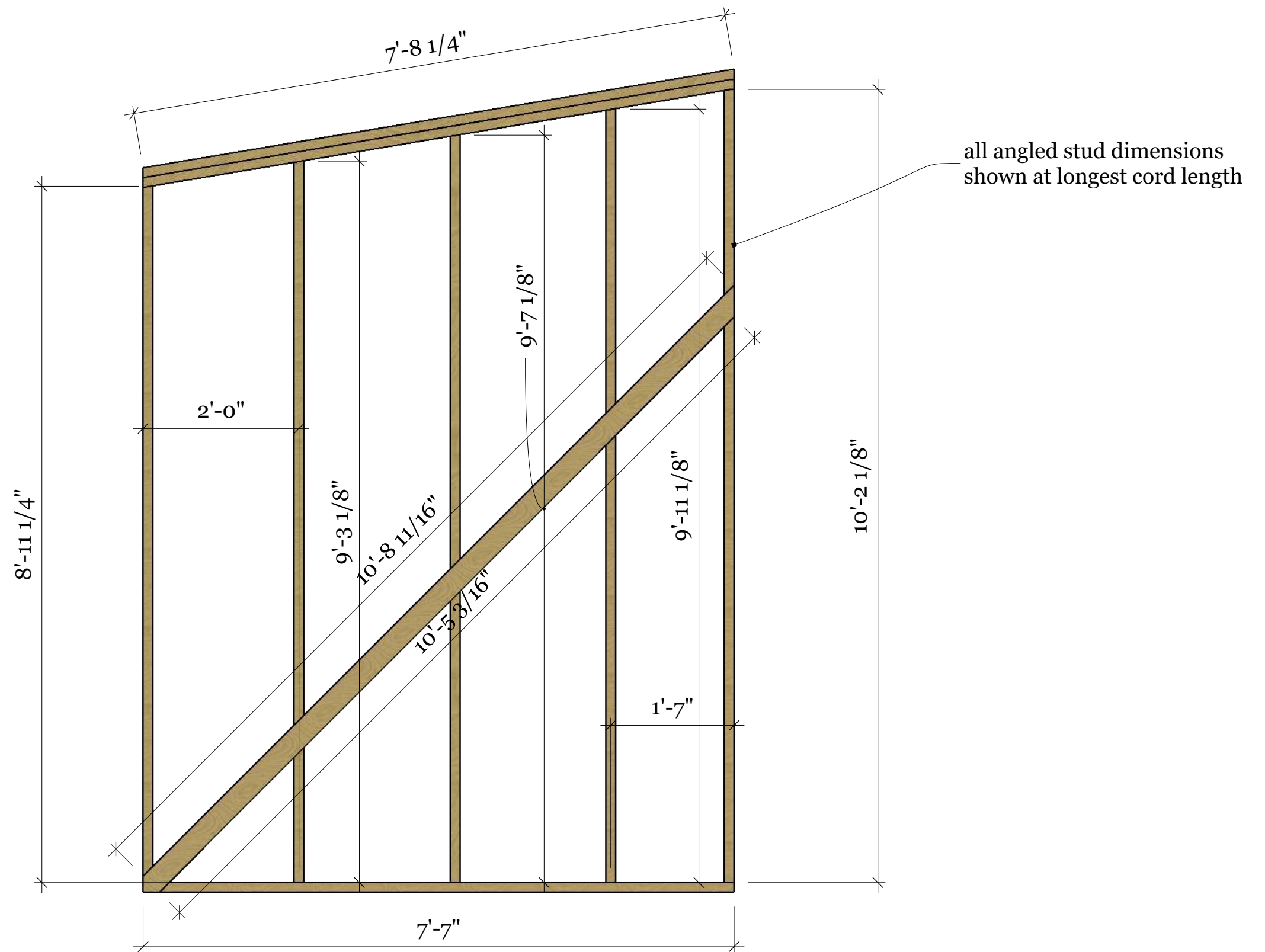

Backcountry Tiny Homes, LLC  
26 Owens Court  
Suite 6  
Hampstead, NH 03841

## Framing North - Dimensions

Model Type: Custom

Designer Name: Tina  
Client Name(s): Peggy  
Project Number: BTH0095-PL  
Draft: Framing Plans  
Date: June 3, 2021

double top plate

2:12

all 2x4 construction unless stated otherwise

1X4 cut-in lateral brace, 45-degree

See Detail #4

## Framing North - Details

Model Type: Custom

Designer Name: Tina  
Client Name(s): Peggy  
Project Number: BTH0095-PL  
Draft: Framing Plans  
Date: June 3, 2021



Backcountry Tiny Homes, LLC  
26 Owens Court  
Suite 6  
Hampstead, NH 03841

03

A

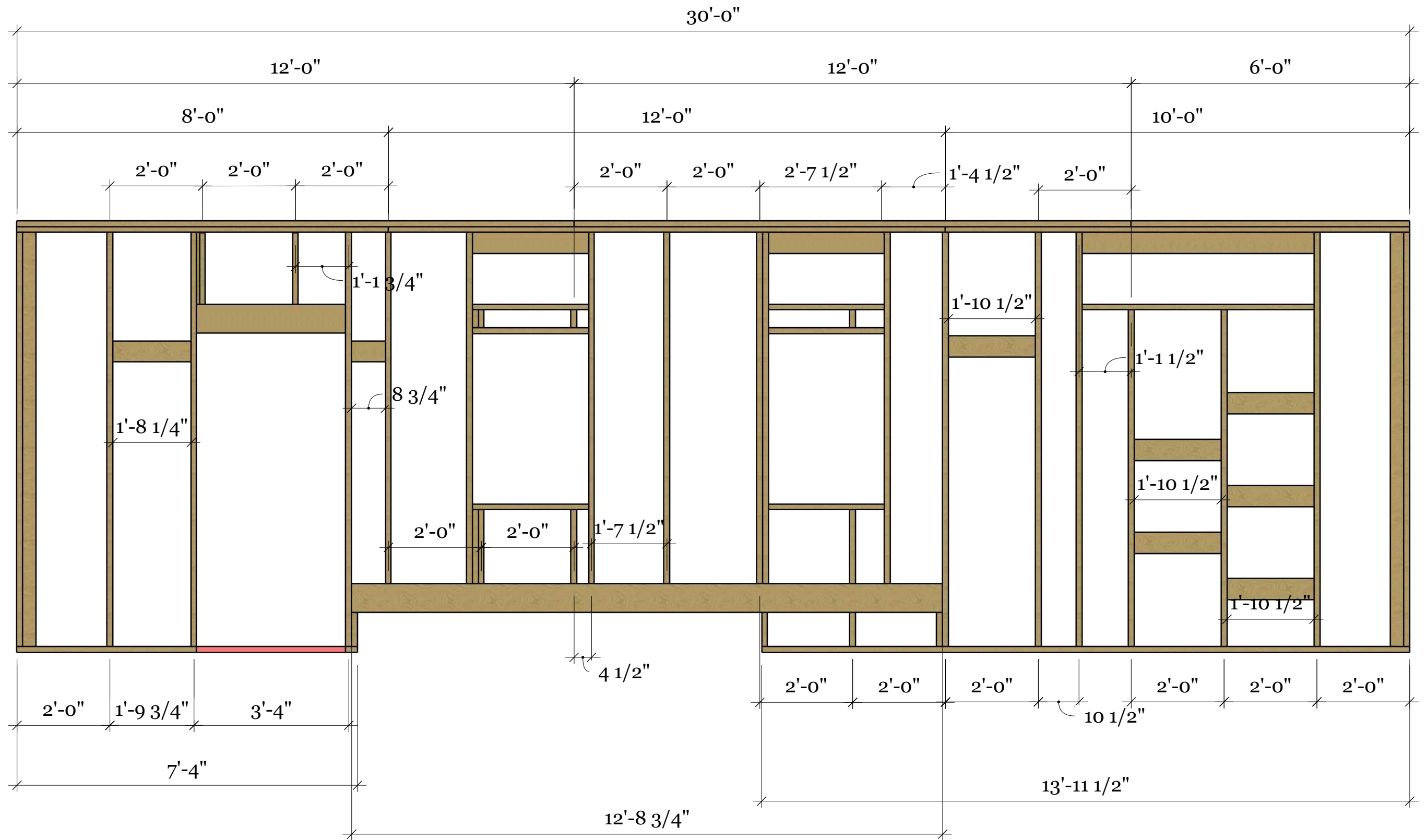

Backcountry Tiny Homes, LLC  
26 Owens Court  
Suite 6  
Hampstead, NH 03841

## Framing East - Dimensions I

Model Type: Custom

Designer Name: Tina  
Client Name(s): Peggy  
Project Number: BTH0095-PL  
Draft: Framing Plans  
Date: June 3, 2021

04

A

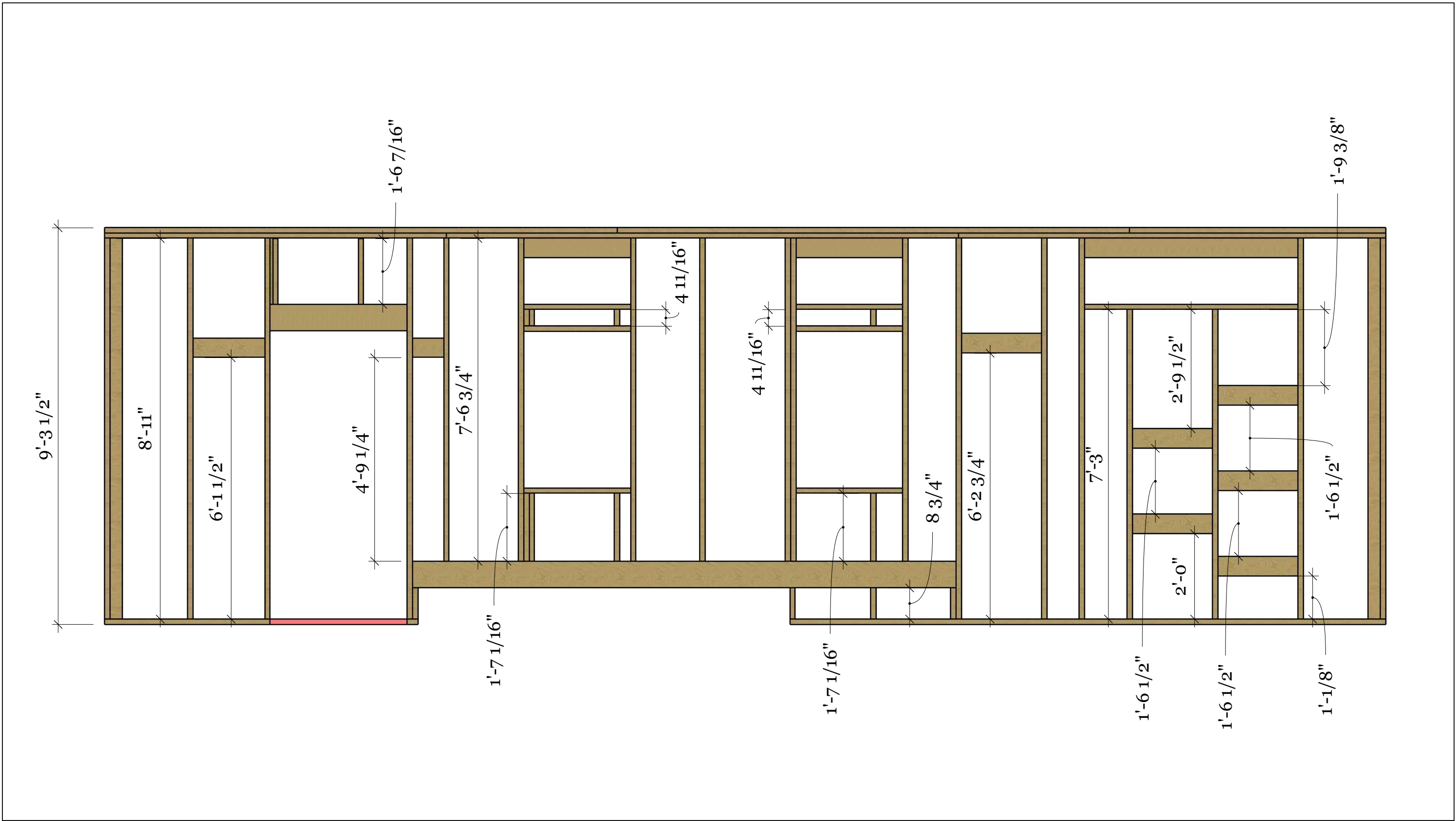



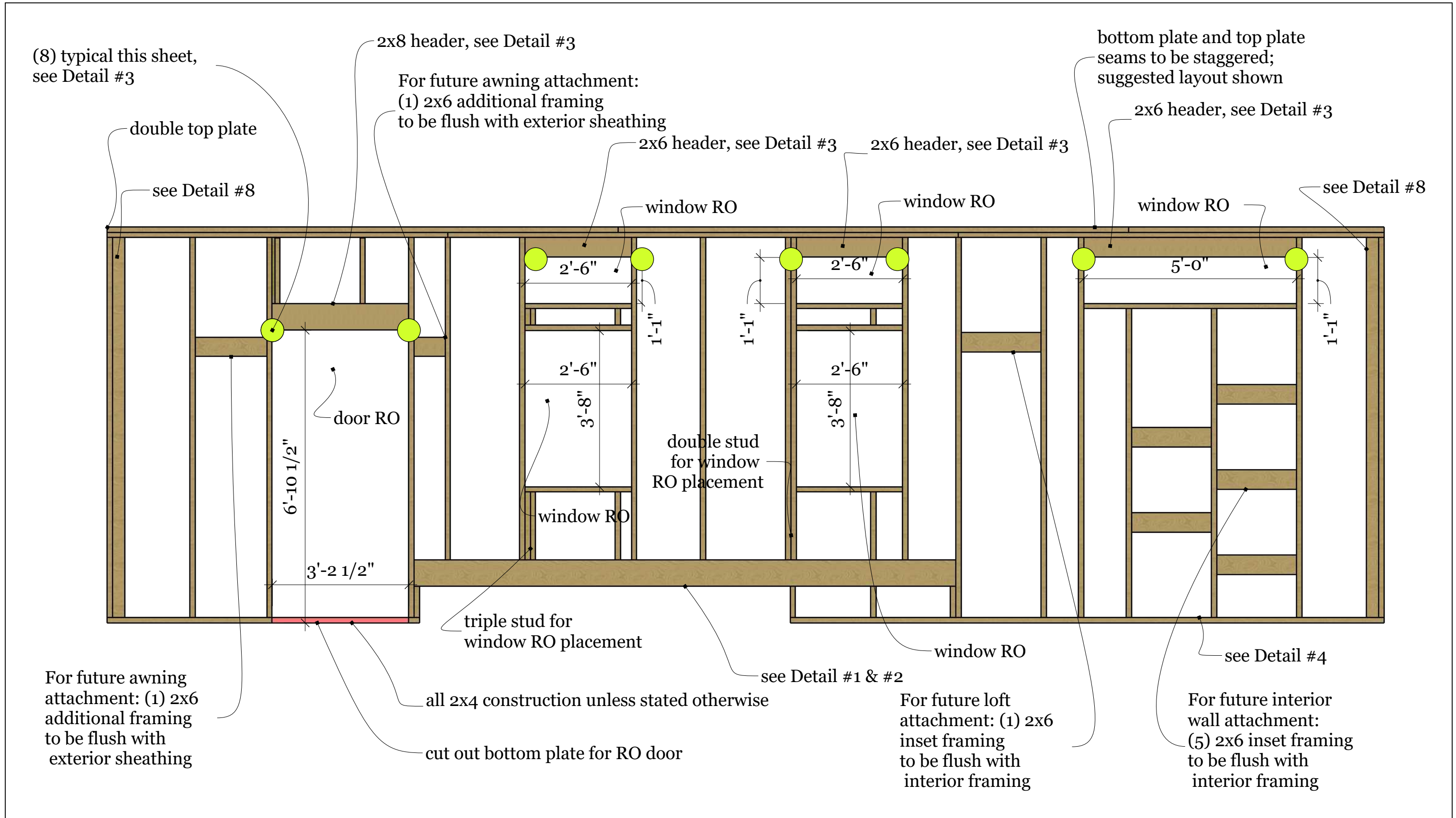

Backcountry Tiny Homes, LLC  
26 Owens Court  
Suite 6  
Hampstead, NH 03841

## Framing East - Details

Model Type: Custom

Designer Name: Tina  
Client Name(s): Peggy  
Project Number: BTH0095-PL  
Draft: Framing Plans  
Date: June 3, 2021

06

A

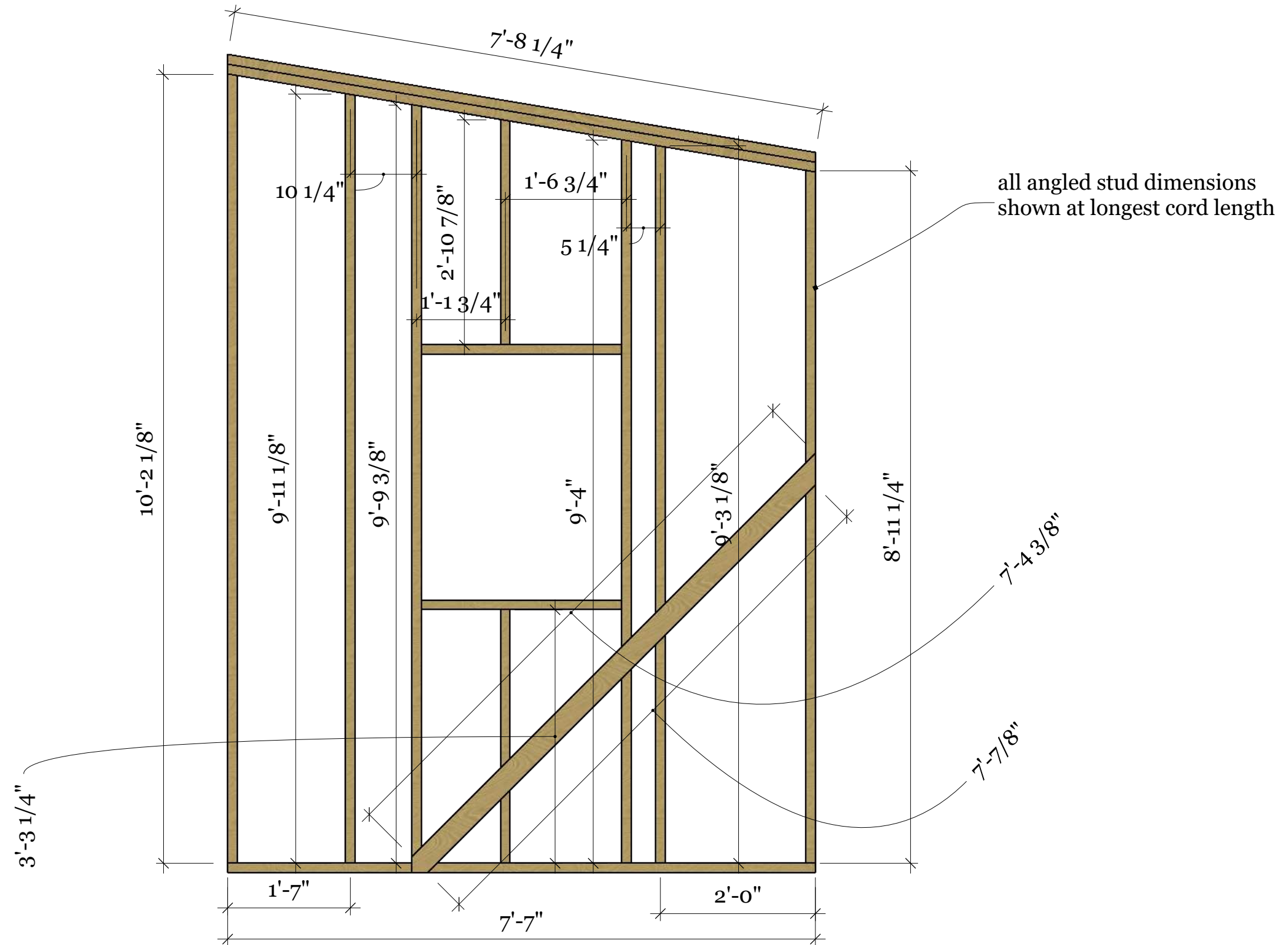

Backcountry Tiny Homes, LLC  
26 Owens Court  
Suite 6  
Hampstead, NH 03841

## Framing South - Dimensions

Model Type: Custom

Designer Name: Tina  
Client Name(s): Peggy  
Project Number: BTH0095-PL  
Draft: Framing Plans  
Date: June 3, 2021

07

A

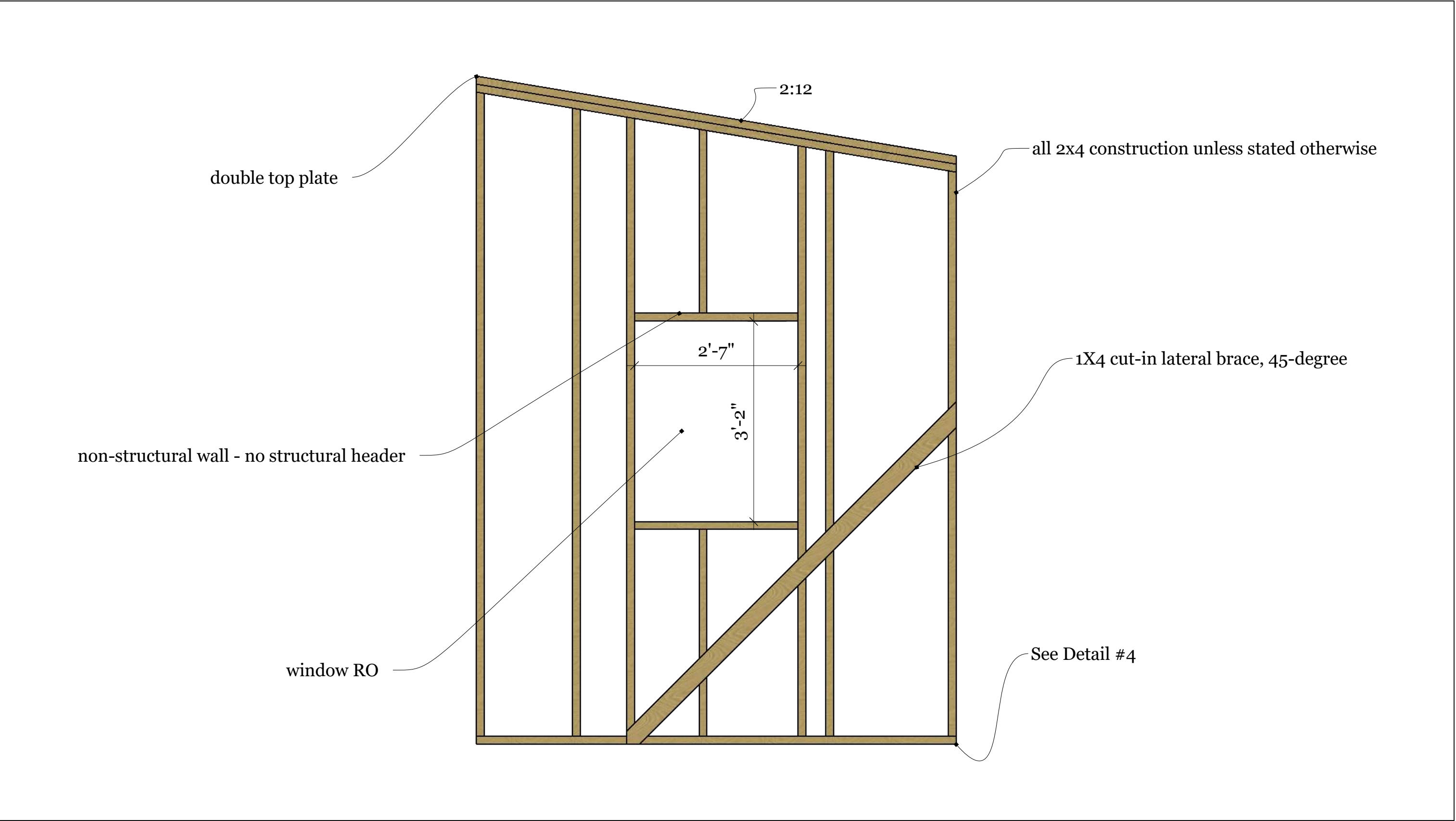



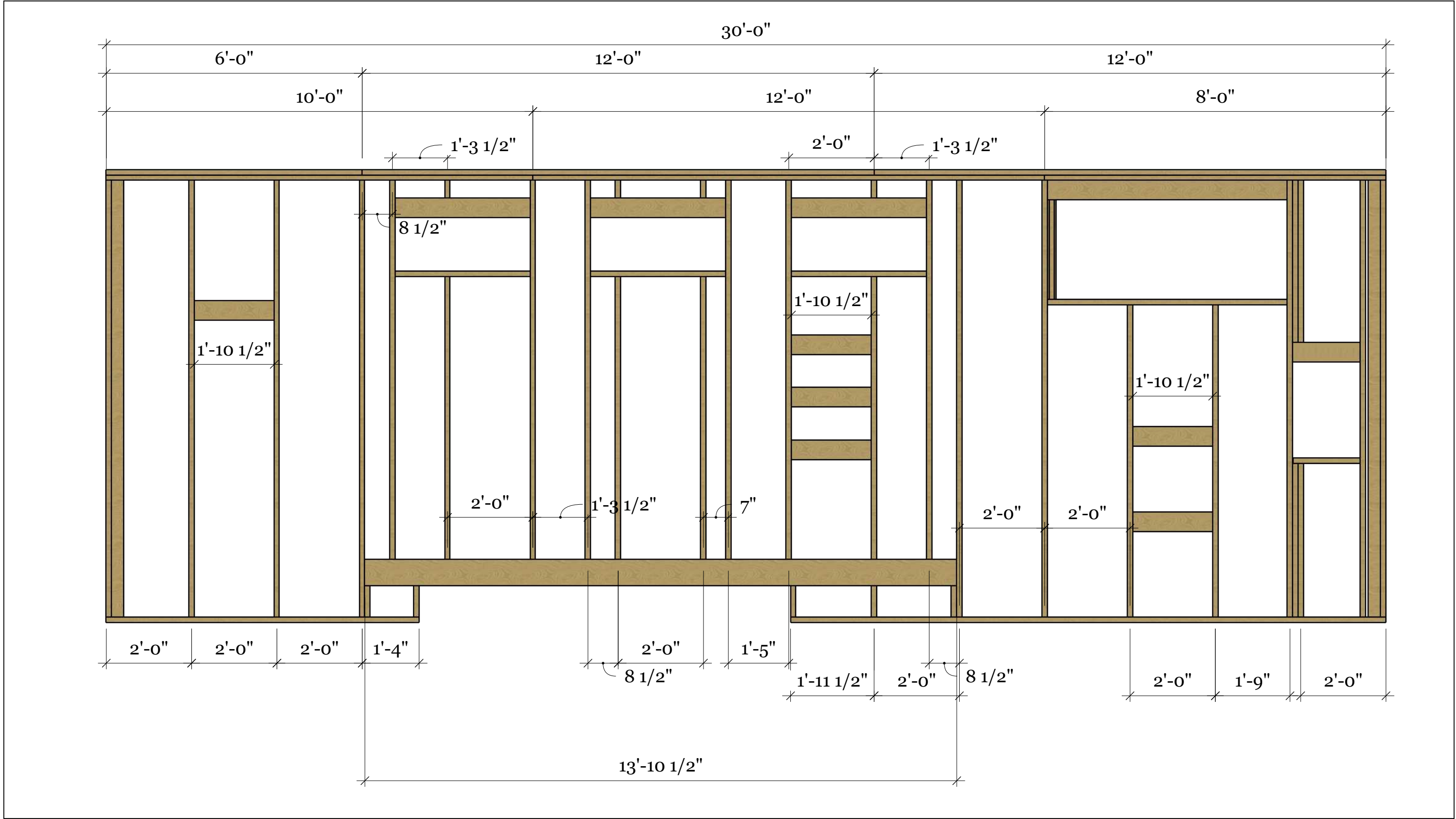

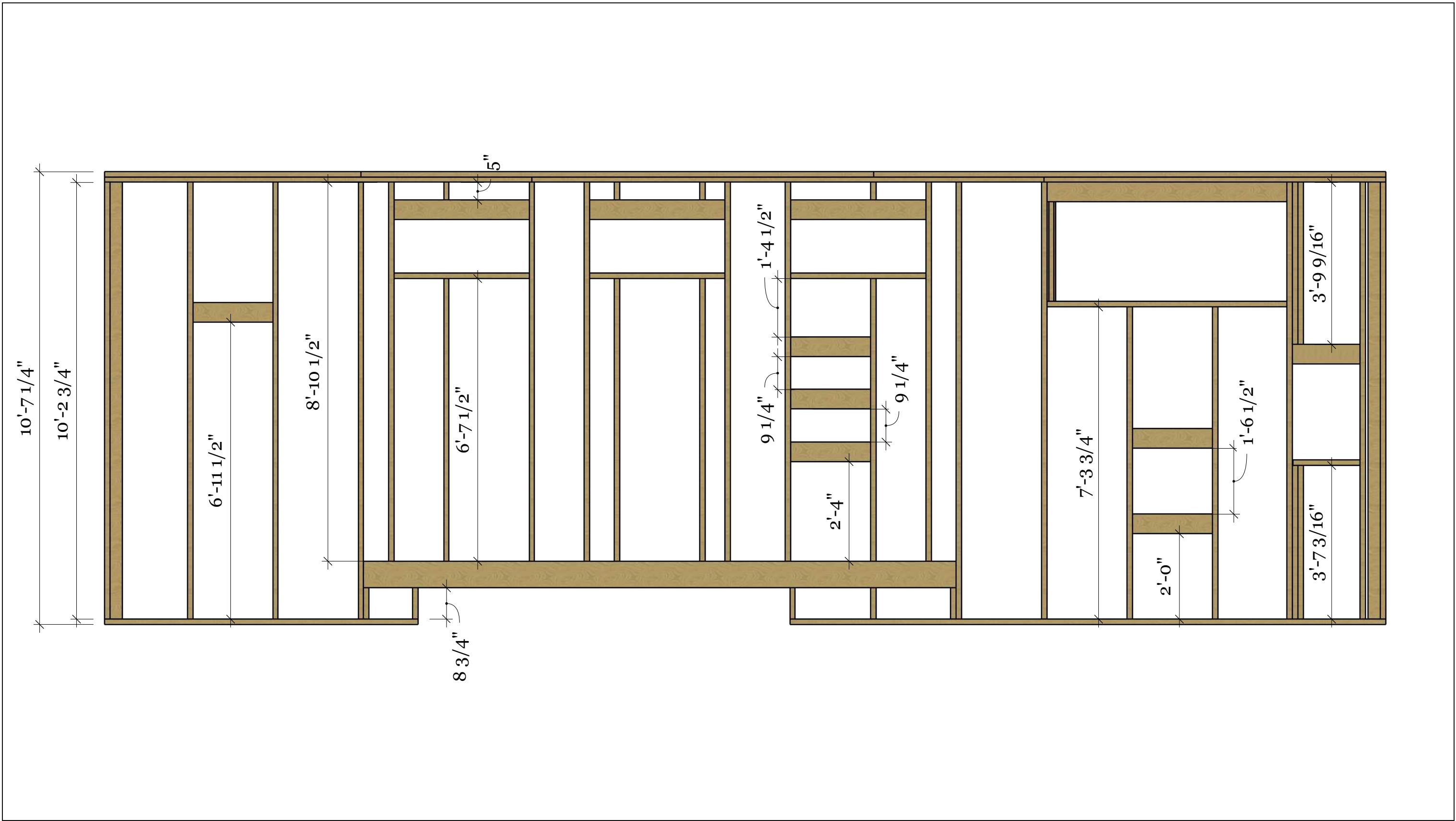



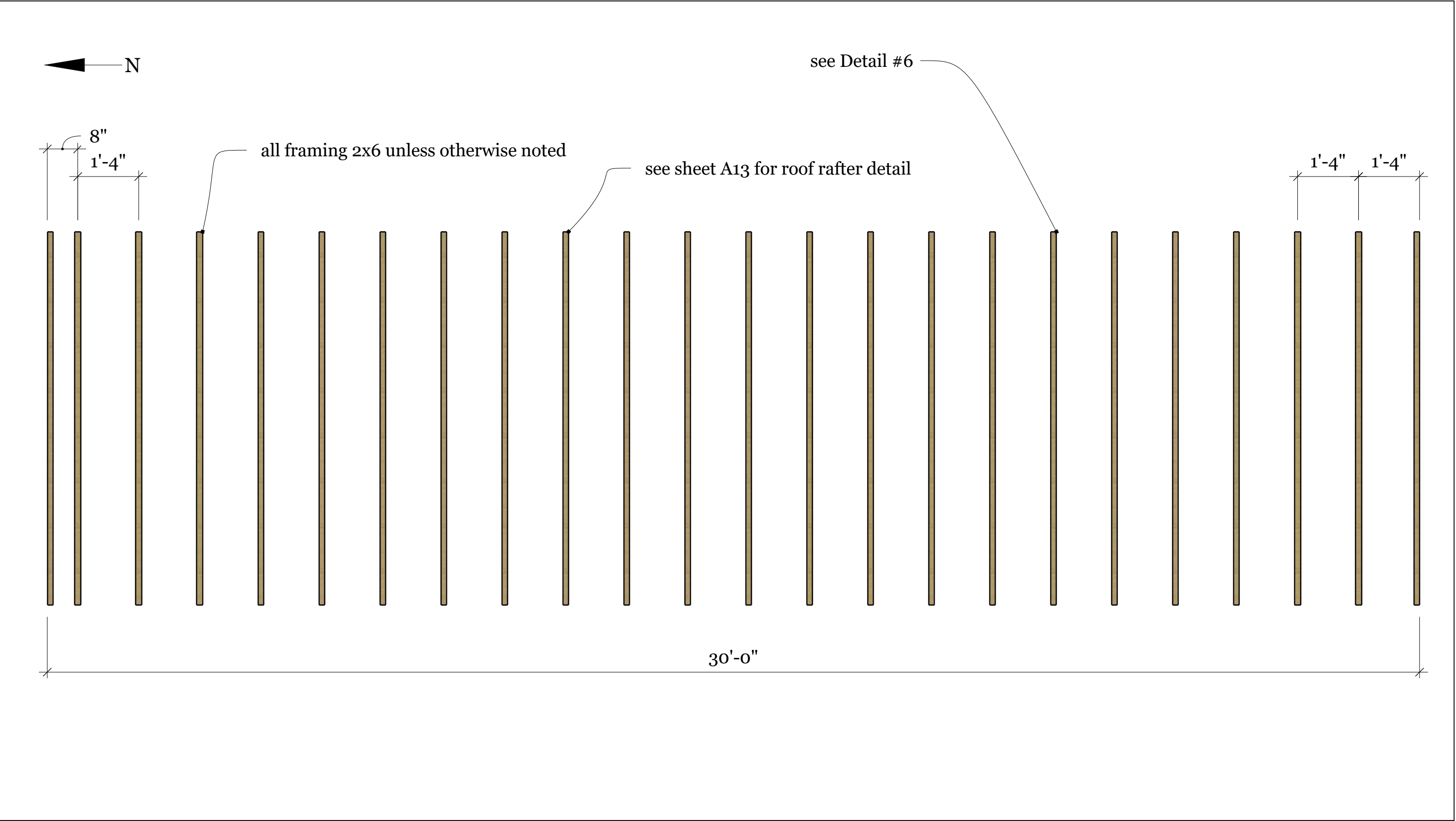

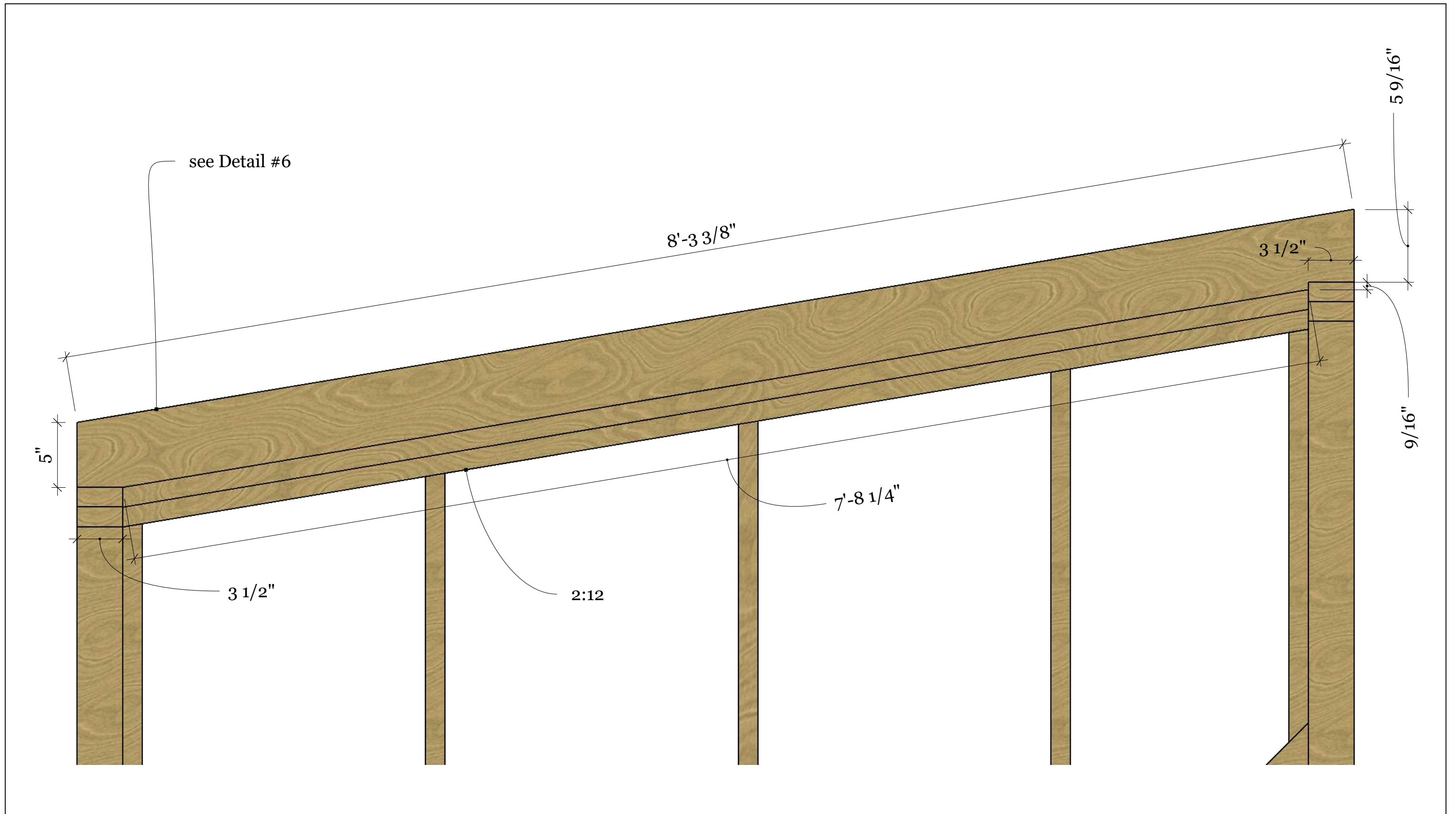

Backcountry Tiny Homes, LLC  
26 Owens Court  
Suite 6  
Hampstead, NH 03841

## Framing Roof - Details

Model Type: Custom

Designer Name: Tina  
Client Name(s): Peggy  
Project Number: BTH0095-PL  
Draft: Framing Plans  
Date: June 3, 2021



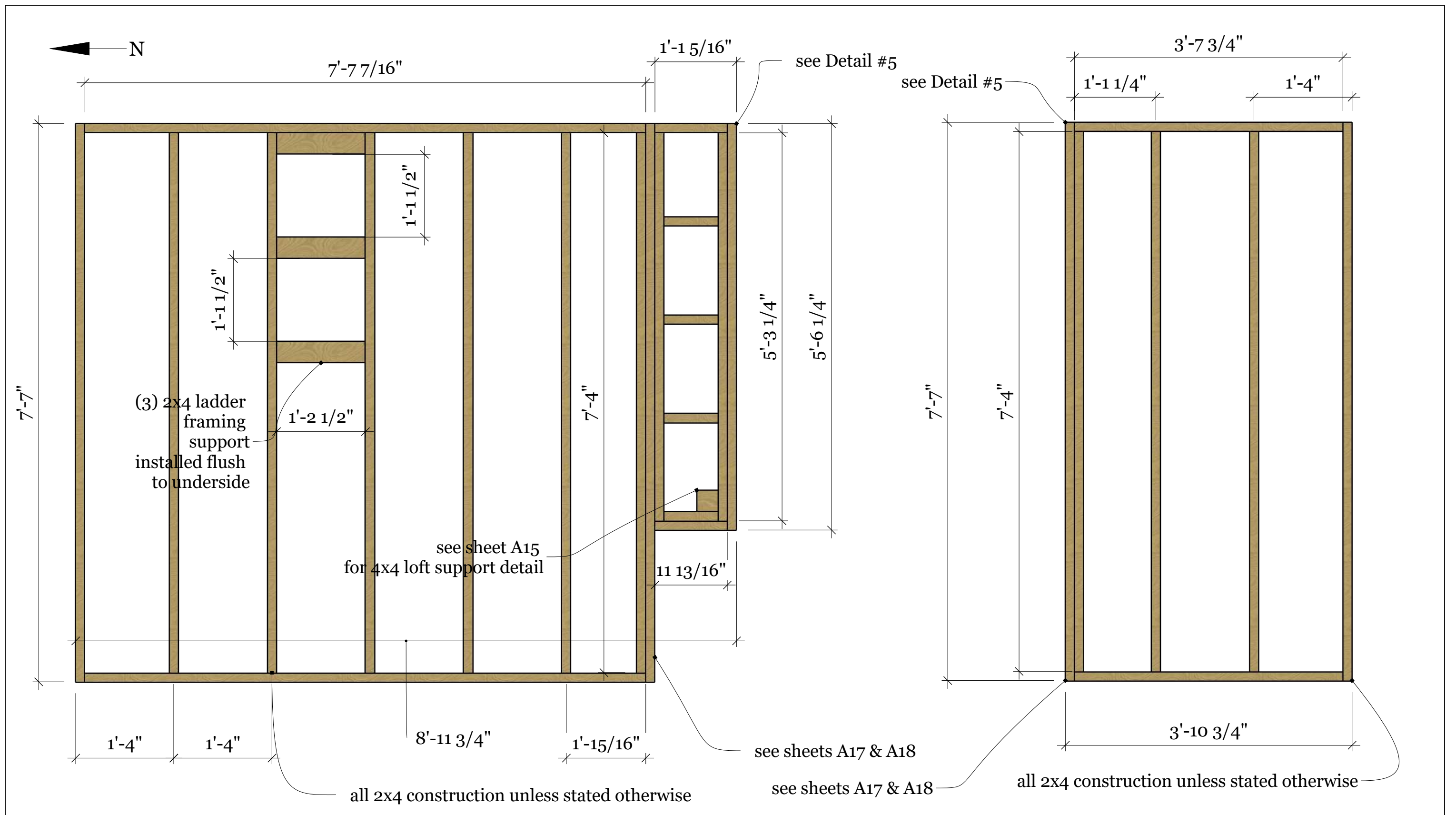

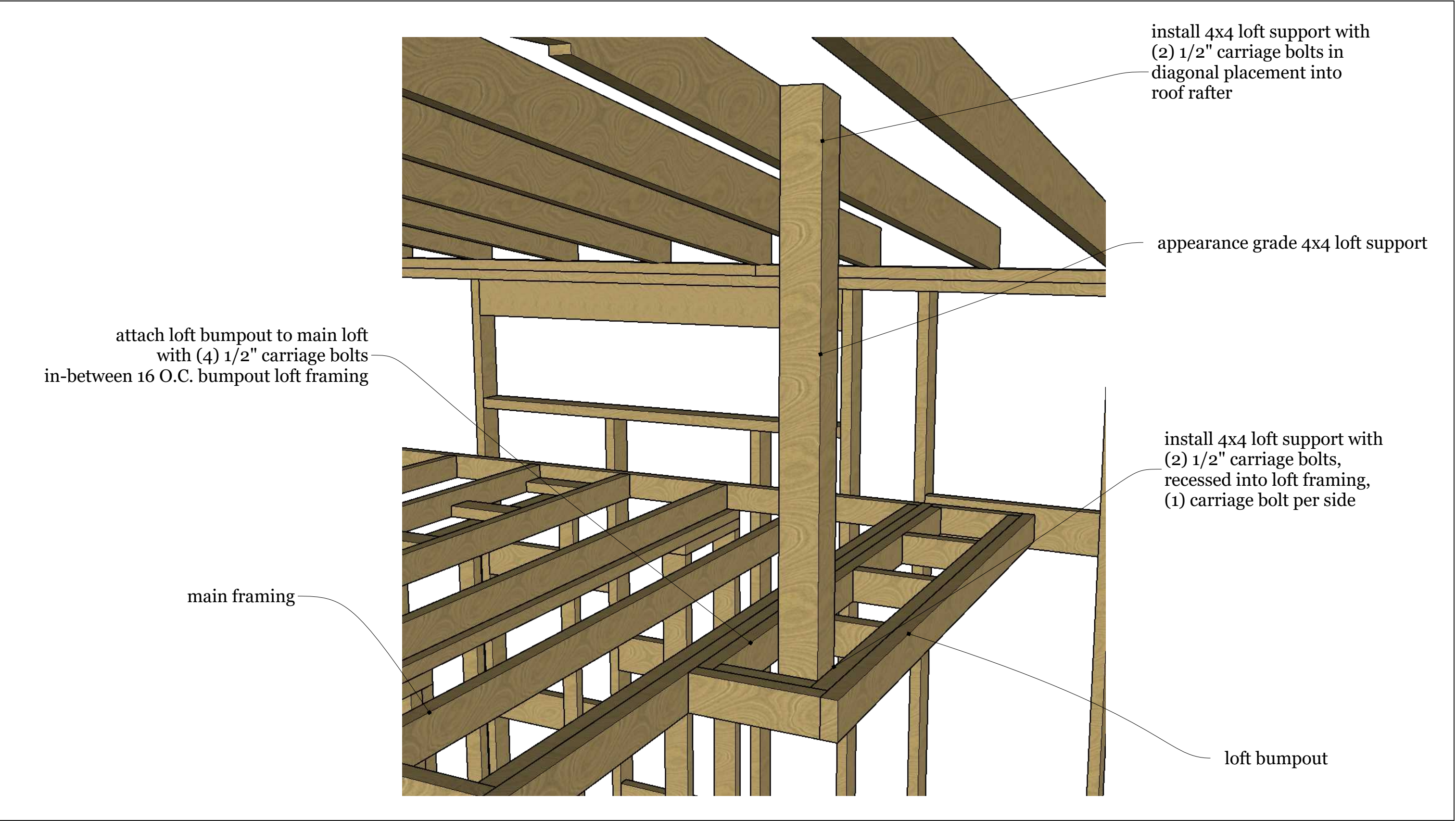

# Framing Lofts - Details

Model Type: Custom

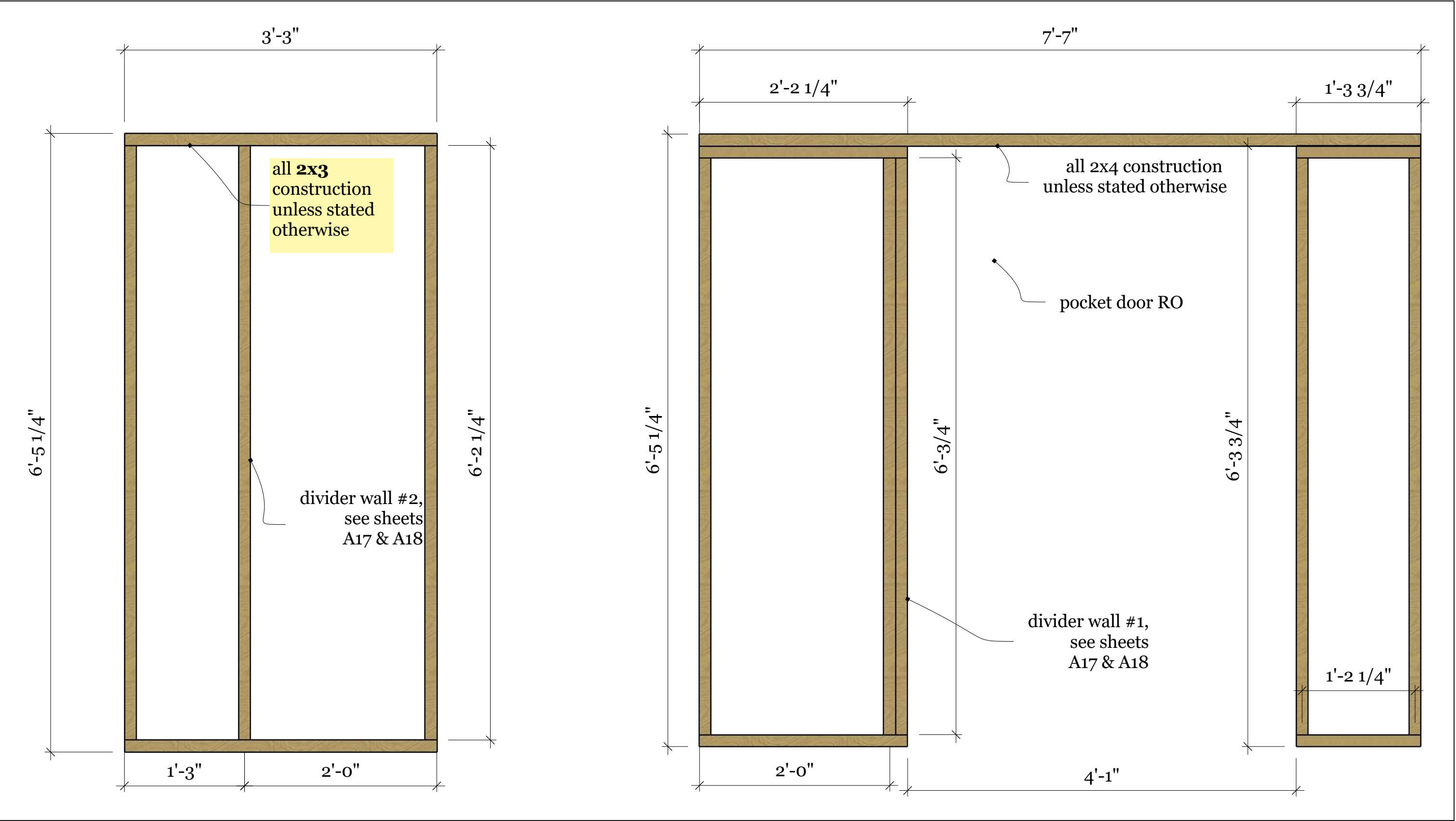



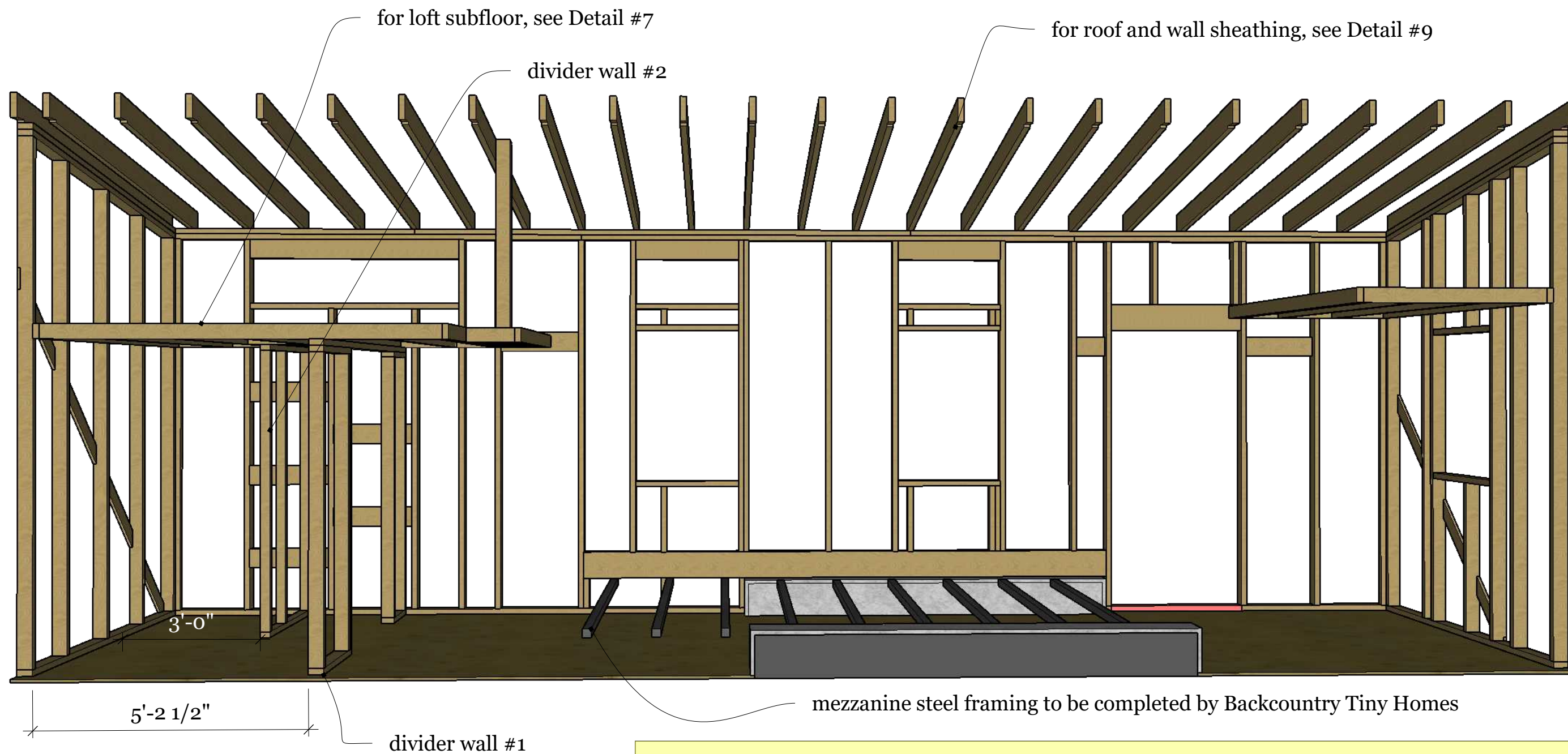

**Note: ZIP panels do not require housewrap unless siding requires it. LP SmartSide requires drainable housewrap to be installed.**



Backcountry Tiny Homes, LLC  
26 Owens Court  
Suite 6  
Hampstead, NH 03841

West POV

Model Type: Custom

Designer Name: Tina  
Client Name(s): Peggy  
Project Number: BTH0095-PL  
Draft: Framing Plans  
Date: June 3, 2021



for loft support attachment, see sheet A15

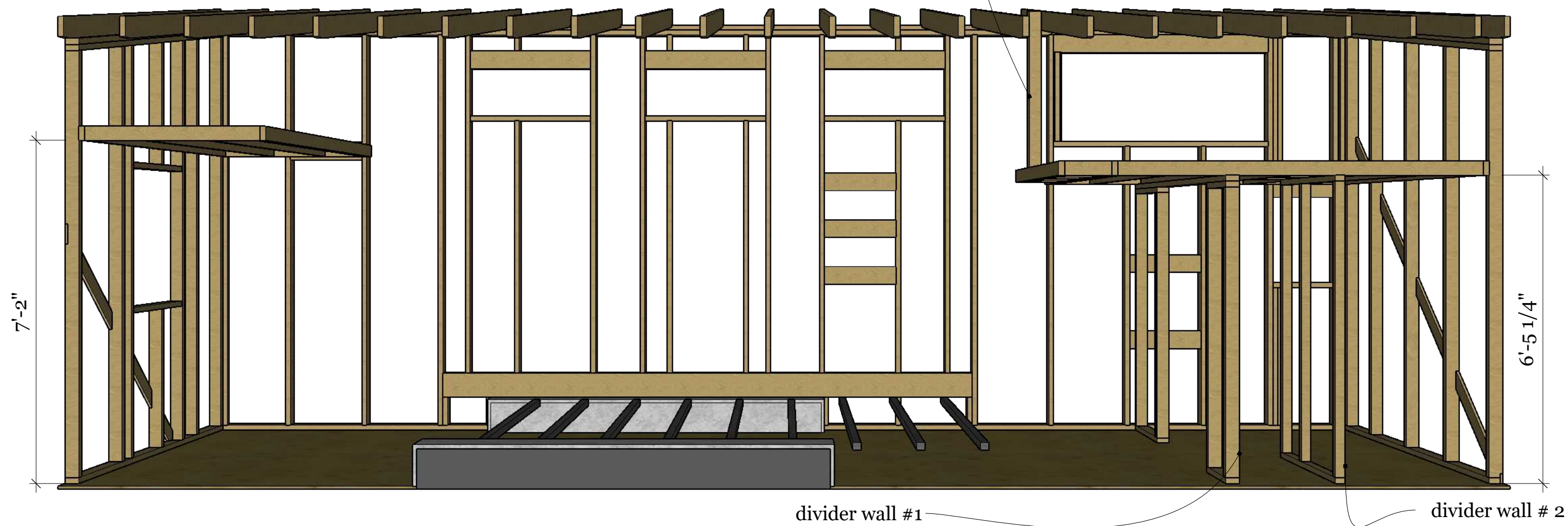

**Note: ZIP panels do not require housewrap unless siding requires it. LP SmartSide requires drainable housewrap to be installed.**



Backcountry Tiny Homes, LLC  
26 Owens Court  
Suite 6  
Hampstead, NH 03841

East POV

Model Type: Custom

Designer Name: Tina  
Client Name(s): Peggy  
Project Number: BTH0095-PL  
Draft: Framing Plans  
Date: June 3, 2021