

Shell Construction Plans

Table of Contents



- A01 - Table of Contents
- A02 - Visual East
- A03 - Visual West
- A04 - Visual North & South
- A05 - Visual Roofing
- A06 - Z-Flashing Detail
- A07 - Awning Detail
- A08 - LP SmartSide Details I
- A09 - LP SmartSide Details II
- A10 - Metal Roofing/Siding Details I
- A11 - Metal Roofing/Siding Details II
- A12 - Metal Roofing/Siding Details III



Backcountry Tiny Homes, LLC
26 Owens Court
Suite 6
Hampstead, NH 03841

Table of Contents

Model Type: Custom

Designer Name: Tina
Client Name(s): Peggy
Project Number: BTH0095-PL
Draft: Shell Construction Plans
Date: June 15, 2021

attach awning kickers to vertical LP SmartSide trim; add additional framing behind vertical trim if necessary see sheet A07 for detail

framing requirements due to wheel well placement has moved this door and awning 8" south

for (2) windows sets shown on this sheet, windows may appear closer together due to as-built requirements during framing; if individual window trim cannot fit around each window, have windows share central trim piece

all LP SmartSide siding & trim to be painted and sealed with supplied paint and C920 caulking
see sheets A08 & A09 for installation details

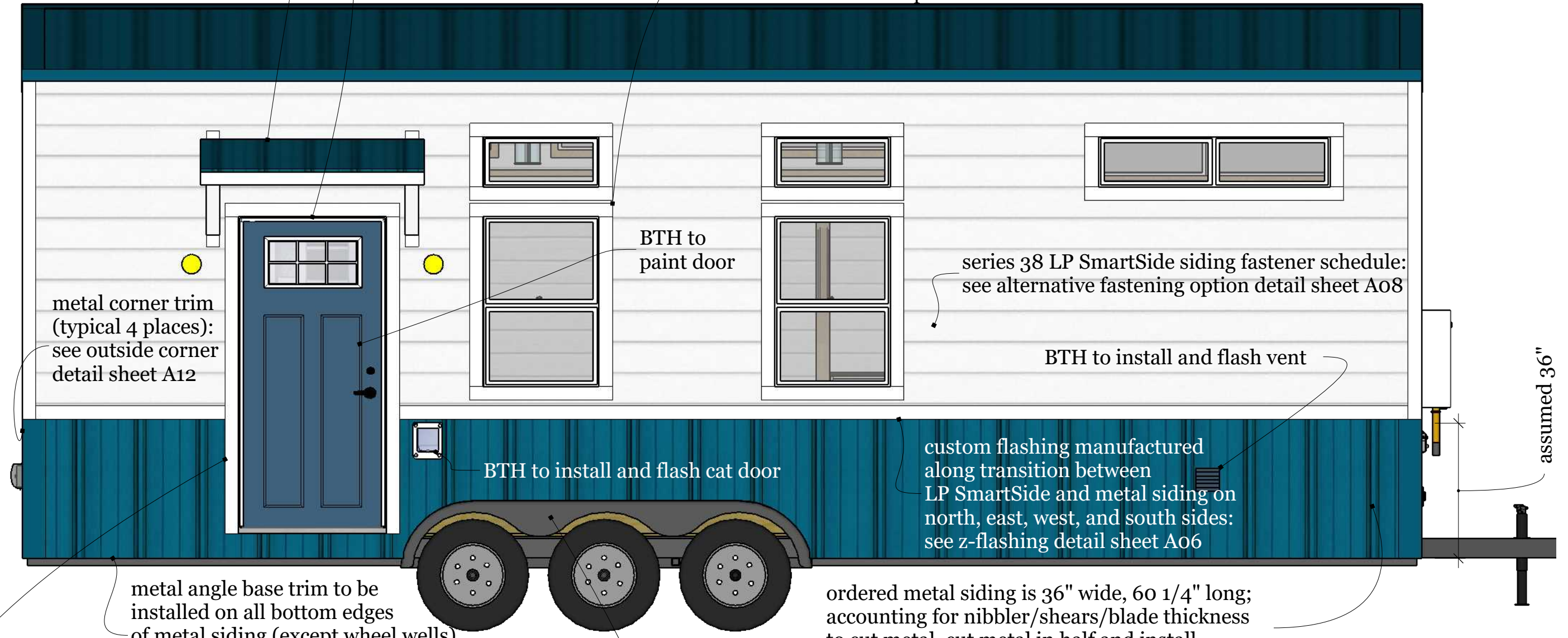

metal corner trim (typical 4 places): see outside corner detail sheet A12

BTH to paint door

series 38 LP SmartSide siding fastener schedule: see alternative fastening option detail sheet A08

BTH to install and flash vent

BTH to install and flash cat door

custom flashing manufactured along transition between LP SmartSide and metal siding on north, east, west, and south sides: see z-flashing detail sheet A06

ordered metal siding is 36" wide, 60 1/4" long; accounting for nibbler/shears/blade thickness to cut metal, cut metal in half and install at half-cut height; assumed 36" height

metal angle base trim to be installed on all bottom edges of metal siding (except wheel wells) on north, east, west, and south side: see angle base detail sheet A12

vertical transitions of LP SmartSide trim and metal siding along door to have j-trim along the edge of the metal siding; see mini-angle/u-flashing detail sheet A12

wheel wells are black and rectangular; install j-trim along the perimeter of the wheel well at the bottom edge of the metal siding: see mini-angle/u-flashing detail sheet A12

assumed 36"



Backcountry Tiny Homes, LLC
26 Owens Court
Suite 6
Hampstead, NH 03841

Visual East

Model Type: Custom

Designer Name: Tina
Client Name(s): Peggy
Project Number: BTH0095-PL
Draft: Shell Construction Plans
Date: June 15, 2021

A 02

all LP SmartSide siding & trim to be painted and sealed with supplied paint and C920 caulking

see sheets A08 & A09 for installation details

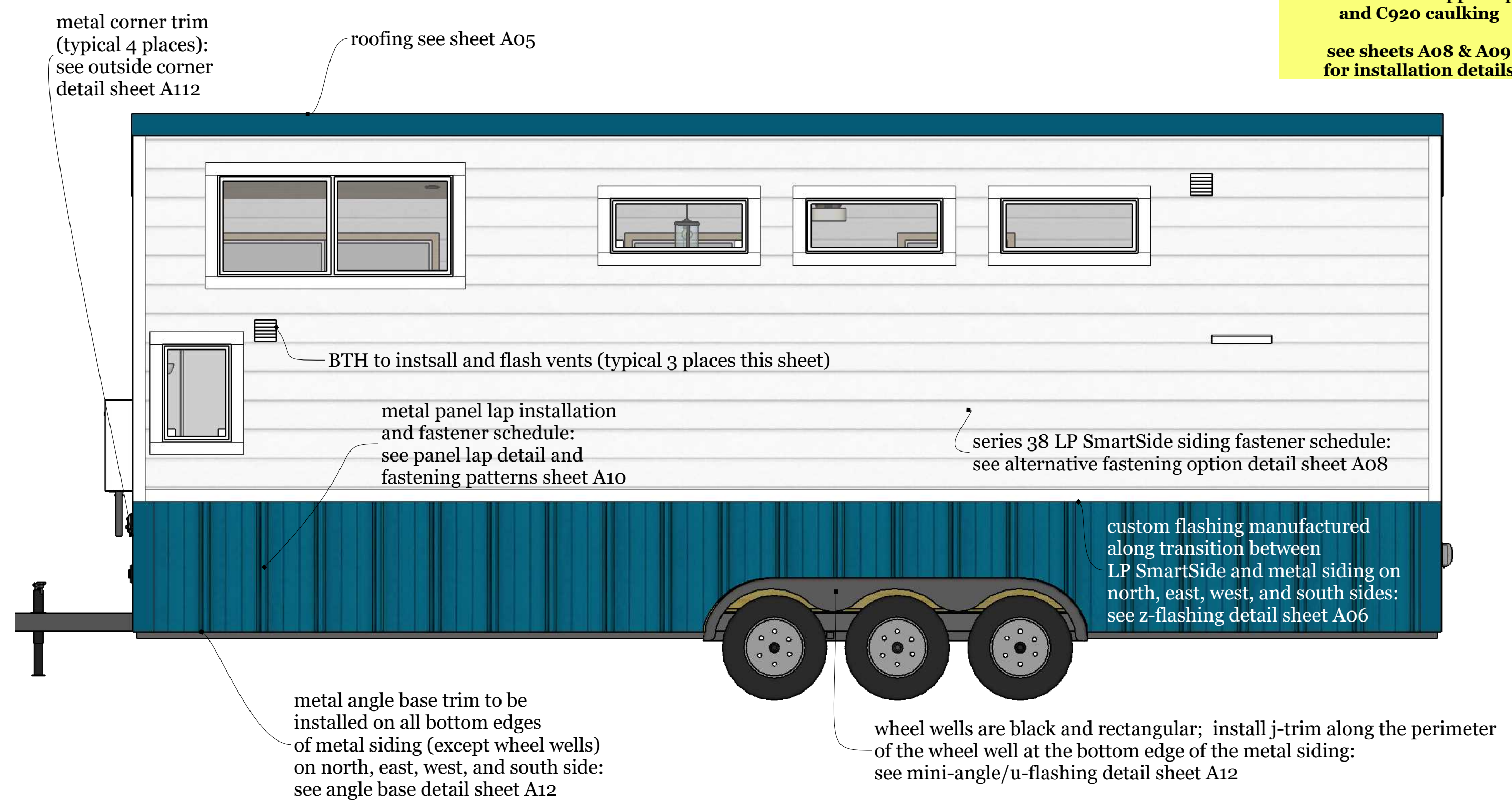

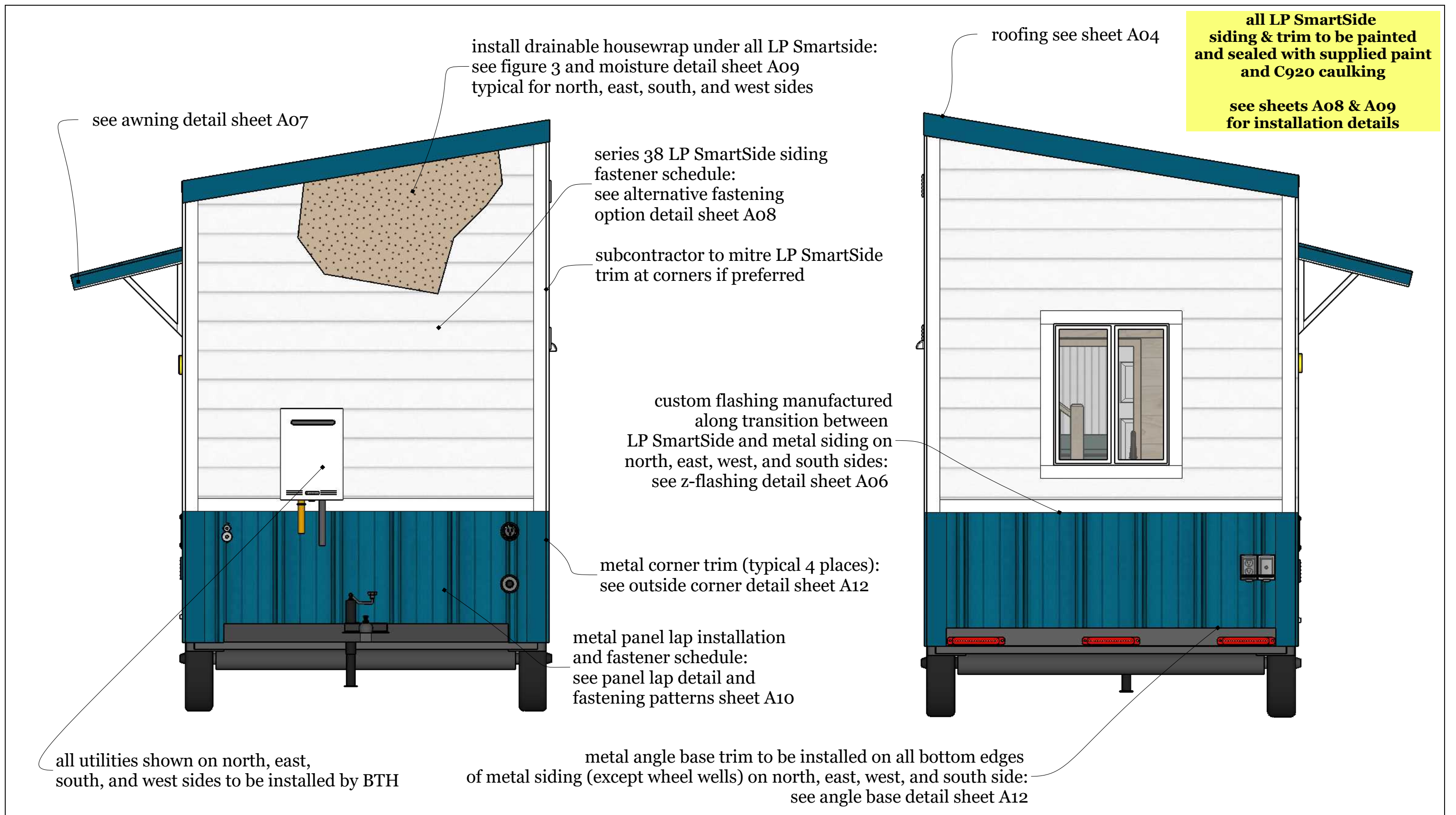

Visual North & South

Model Type: Custom

Prevailing Winds →
← N

metal eave trim along east side: see eave molding detail sheet A11

see awning detail sheet A07

install/lap both metal siding and metal roofing to prevent lifting from the prevailing wind; tiny home will be subjected to hurricane force wind while on the highway with prevailing winds from the North

no metal roofing end closures to be installed

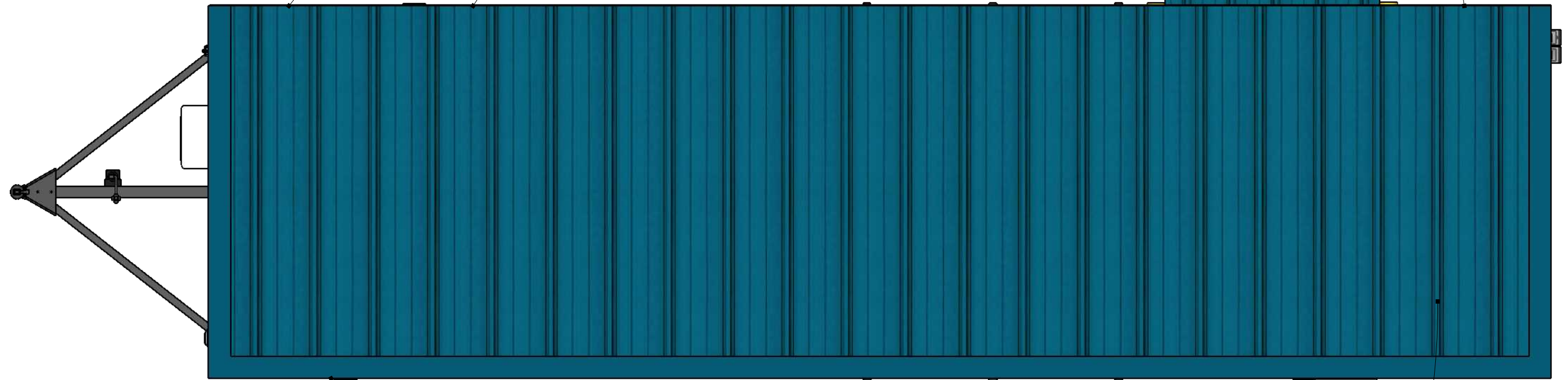

metal gable trim along north, south, west sides: see gable trim detail sheet A11

metal panel lap installation and fastener schedule: see panel lap detail and fastening patterns sheet A10



Backcountry Tiny Homes, LLC
26 Owens Court
Suite 6
Hampstead, NH 03841

Visual Roofing

Model Type: Custom

Designer Name: Tina
Client Name(s): Peggy
Project Number: BTH0095-PL
Draft: Shell Construction Plans
Date: June 15, 2021

05

A

all LP SmartSide siding & trim to be painted and sealed with supplied paint and C920 caulking

see sheets A08 & A09 for installation details

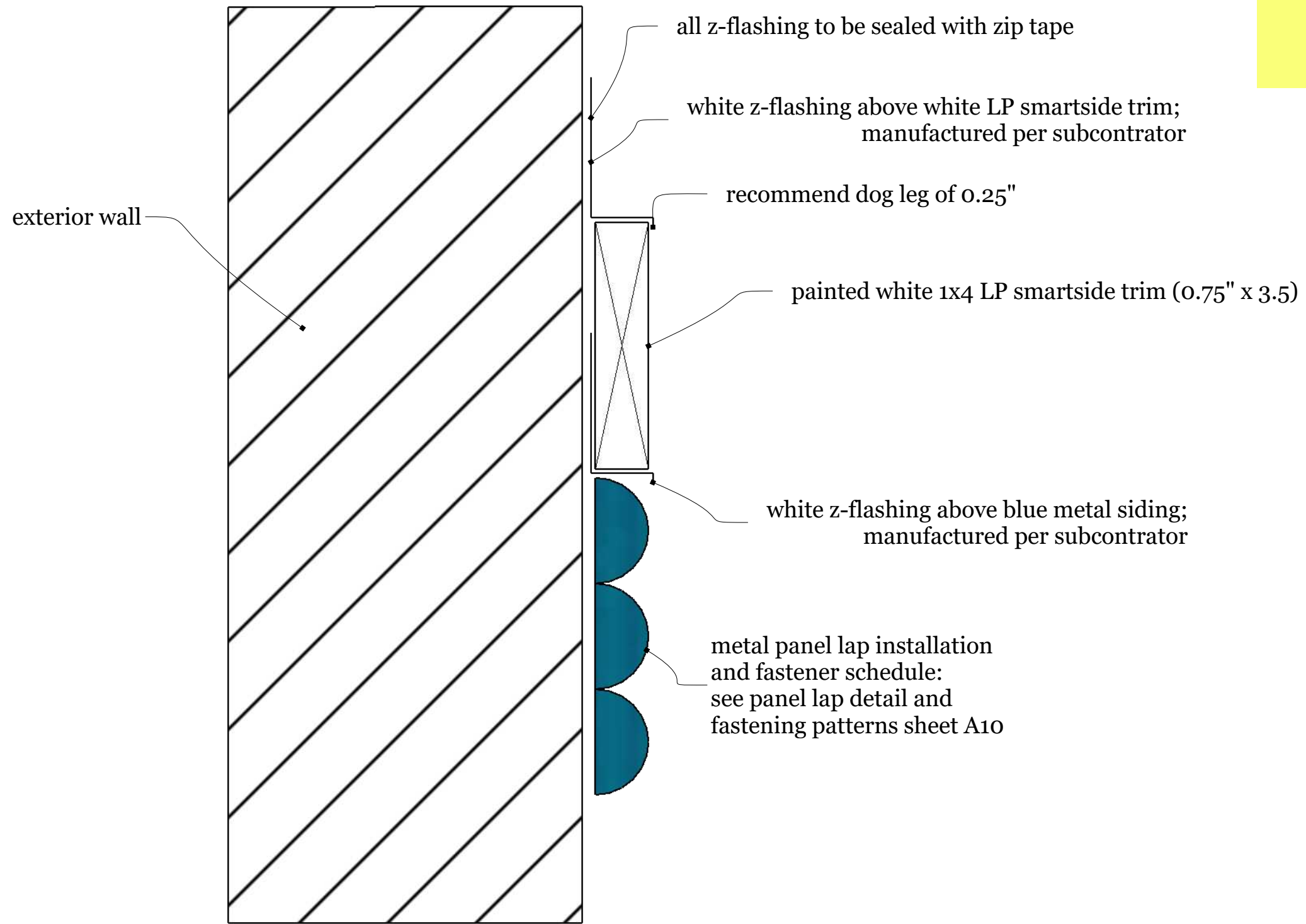

Backcountry Tiny Homes, LLC
 26 Owens Court
 Suite 6
 Hampstead, NH 03841

Z-Flashing Detail

Model Type: Custom

Designer Name: Tina
 Client Name(s): Peggy
 Project Number: BTH0095-PL
 Draft: Shell Construction Plans
 Date: June 15, 2021

06

A

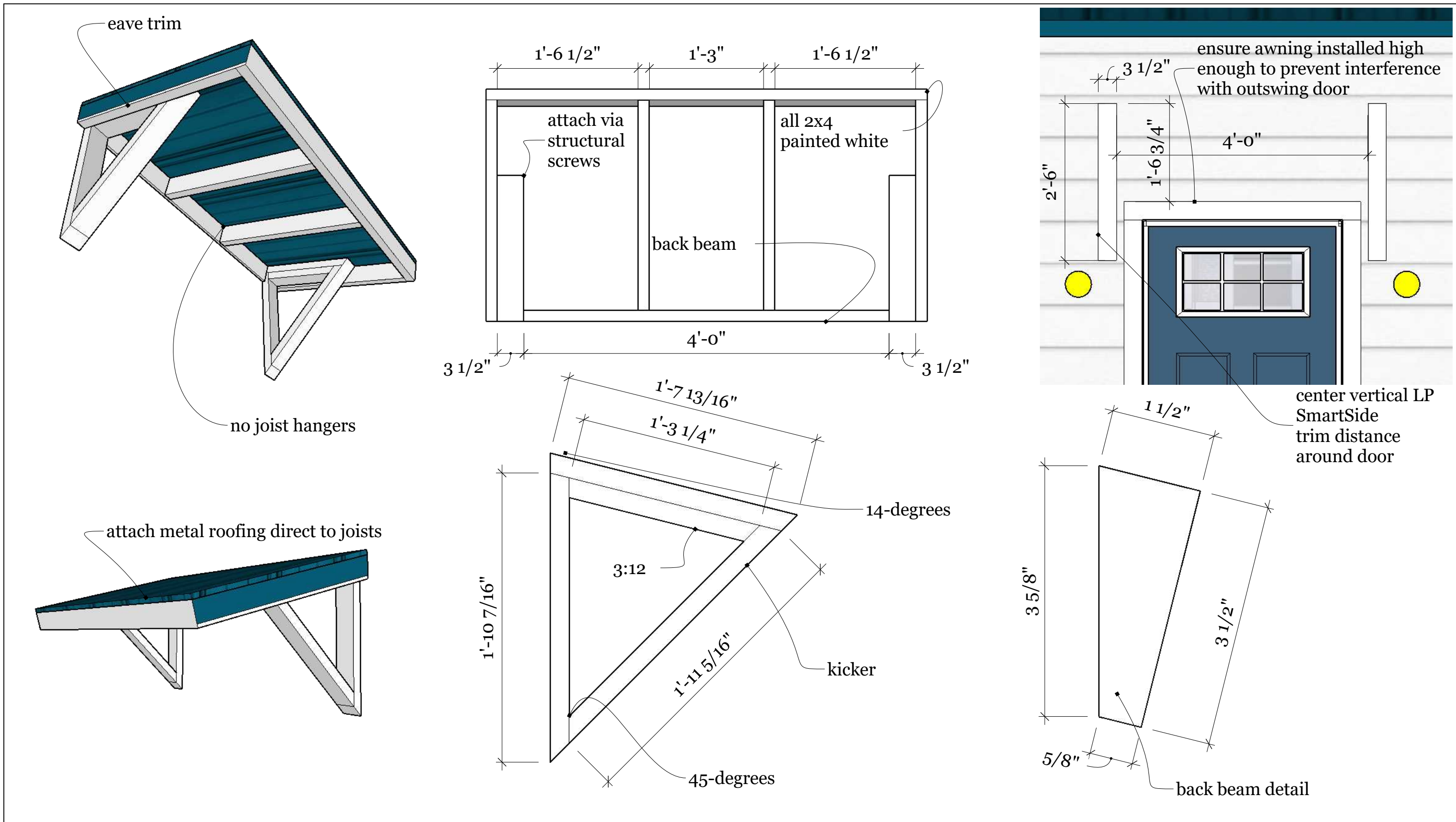

Awning Detail

Model Type: Custom

NAILING INSTRUCTIONS

- LP SmartSide 76 Series lap siding may be attached directly to framing members spaced up to a maximum of 24 in. O.C.
- LP SmartSide 38 Series lap siding may be attached directly to framing members that are spaced up to a maximum of 16 in. O.C.
- Check your local building code before starting to install the siding to confirm if wall sheathing is required.
- Siding joints should be staggered over successive courses. For installation with or without wood structural panels, joints must occur over stud locations.
- Siding shall be installed with top (blind) nailing, with the nails placed 3/8 in. from either end and a minimum of 3/4 in. from the top edge of the board. Fasteners will be exposed on siding located immediately below window sills, fascia boards, and horizontal trim. Fasteners below window sill shall be spaced a maximum of 8 in. O.C.
- Overlap successive courses of siding a minimum of 1 in.

SmartLock Overlap & Blind Fastening

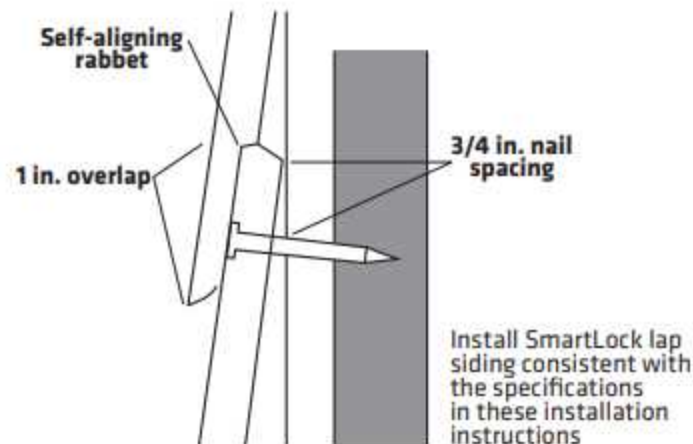

Alternative Fastening Option for (strand) over Wood Structural Panels and 24 in. O.C. Stud Spacing

- Limited to 6 in. and 8 in. wide lap siding.
- Wood structural panels must be a minimum 7/16 Category with an APA Trademark that contains the consensus Standard DOC PS 2.
- 38 Series Precision lap must be fastened with:
 - Minimum #8 hot dip galvanized tapered head wood screw with a 0.270 in. diameter head, spaced a maximum of 12 in. O.C. with 1-1/2 in. screw penetration into each stud or...
 - Minimum 6d (0.091 in. shank diameter) hot dip galvanized ring shank nail with a 0.200 in. diameter head, spaced a maximum of 8 in. O.C. with 1-1/2 in. nail penetration into each stud.

FINISHING INSTRUCTIONS

DO

- **Prime and paint all exposed surfaces including all drip edges or where water will hang.**
- Apply finish coat as soon as possible or within 180 days of application.
- High-quality acrylic latex paint, specially formulated for use on wood and engineered wood substrates, is highly recommended. Semi-gloss or satin finish oil or alkyd paints are acceptable. For flat alkyd paint, please check with the coating manufacturer for their recommendations for use on composite wood siding.
- Follow the coating manufacturer's application and maintenance instructions.

DO NOT USE

- Semi-transparent and transparent stains.
- Shake and shingle paints.
- Vinyl-based resin formulas such as vinyl acetate, PVA, vinyl acetate/acrylic copolymer paints.

HANDLE PREFINISHED LP SMARTSIDE PRODUCTS WITH EXTREME CARE DURING STORAGE AND APPLICATION. TOUCH UP ANY DAMAGE TO THE FINISH THAT MAY OCCUR DURING APPLICATION PER PREFINISHERS SPECIFICATIONS.

CONDITION	CORRECTION
Snug	OK
Flush	Paint
Visible fiber	Paint
Countersunk 1/16" - 1/8"	Apply sealant
Countersunk more than 1/8"	Apply sealant and re-nail

- All exposed face nails must be caulked and sealed in a manner that prevents moisture intrusion and water buildup.
- Penetrate structural framing or wood structural panels and structural framing a minimum of 1-1/2 inches (38 mm).
- Nail from the center of the siding toward the ends, or from one end to the other end. NEVER nail from the ends of the siding toward the middle.
- Shim siding at studs as needed, to avoid drawing siding against uneven walls. Do not overdrive nails. Nail head should seat firmly to face of siding but not be overdriven to distort the siding surface.
- For information on fastening LP SmartSide products in high wind speed areas, refer to ICC-ES Report ESR-1301 or APA PR-N124.

BUTT JOINTS

Figure 2

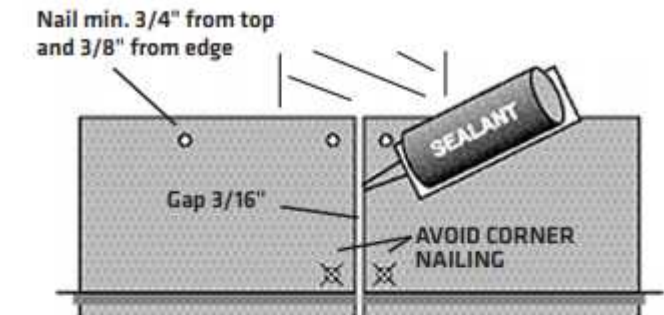

- A minimum 3/16 inch (5 mm) gap is required at ALL butt joints.
- Butt joint can be finished in one of four options indicated below:
 1. **If joint sealant (caulking) option is selected**, seal all gap at butt joints with a high-quality exterior sealant meeting ASTM C920, minimum Class 25 sealant.
 2. **If joint moulding option is selected**, add the thickness of the web to the butt joint gap allowing a net 3/16 inch (5 mm) space for expansion.
 3. **If siding is factory prefinished**, butt joints do not require sealant or joint moulding when factory finish is maintained on both butt joint ends, and joint is flashed with a minimum 4 inch (102 mm) wide flashing.
 4. **If open butt joints (no caulking or moulding) are desired on primed siding**, joint must be flashed with a minimum 4" wide flashing, factory primed ends must be maintained on both sides of butt joint, and factory primed ends must be coated with an additional layer of high-quality water based primer per coating manufacturers requirements prior to installation of siding.



Backcountry Tiny Homes, LLC
26 Owens Court
Suite 6
Hampstead, NH 03841

LP SmartSide Details I

Model Type: Custom

Designer Name: Tina
Client Name(s): Peggy
Project Number: BTH0095-PL
Draft: Shell Construction Plans
Date: June 15, 2021

08

A

Figure 3

Over Openings

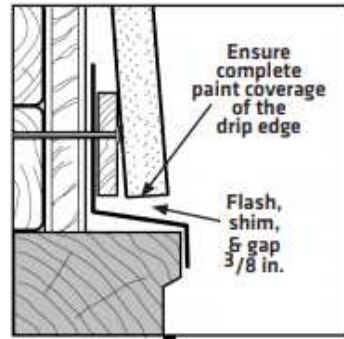

Figure 3A

Alternate Butt Joint Treatments

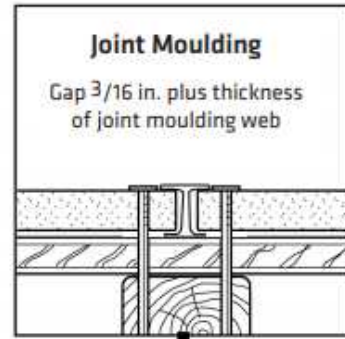

Figure 3B

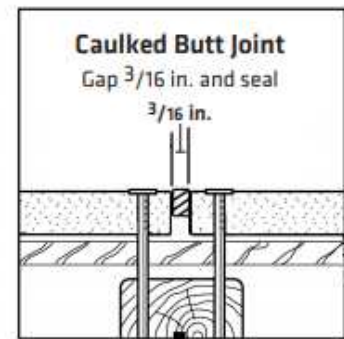

Figure 3C

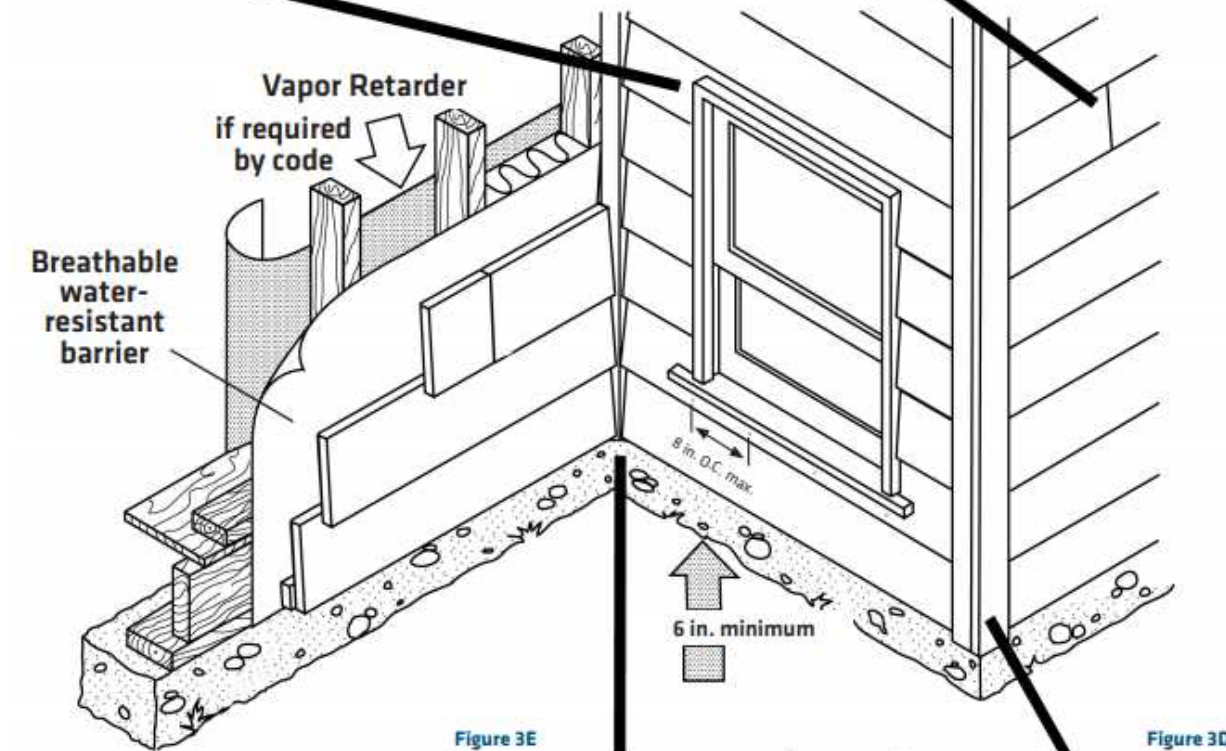
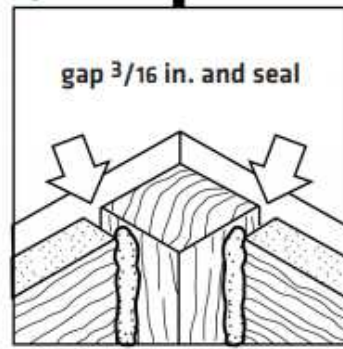
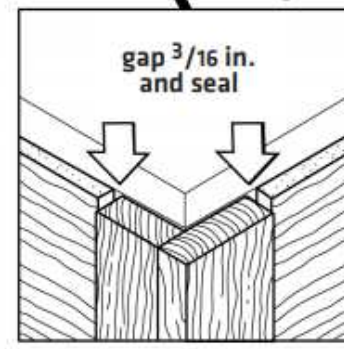

Figure 3E



Inside Corner Detail



Outside Corner Detail

MOISTURE

- Moisture control and moisture vapor control are critical elements of proper housing design. Check your local building codes for application procedures for handling moisture and water vapor in your area.
- When using wet blown cellulose insulation, the insulation must not be in direct contact with the siding and it must be allowed to dry a minimum of 24 hours or longer if specified by the insulation manufacturer.
- As with all wood products, do not apply engineered wood siding to a structure having excessive moisture conditions such as drying concrete, plaster or wet blown cellulose insulation. If such conditions exist, the building should be well ventilated to allow it to dry prior to the application of the siding.
- Siding must not be applied to green or crooked structural framing members. Do not apply siding over rain-soaked or buckled sheathing materials.
- Gutters are recommended for control of roof water run off.

WATER-RESISTANT BARRIER (WRB)

- A properly installed water-resistant barrier is required behind siding. Consult your local building code for details.
- The LP SmartSide limited warranty does not expressly or implicitly cover water penetration. LP does not assume responsibility for any water penetration.

GAPS & SEALANTS

- Seal all gaps with a high-quality, non-hardening, paintable sealant meeting ASTM C920, minimum Class 25.
- Follow the sealant manufacturer's instructions for application.

FLASHING, WINDOWS, DOORS & OPENINGS

- All openings must be properly sealed or flashed in a manner that prevents moisture intrusion or buildup. Several examples that accomplish this are shown on the following pages.

GENERAL

- At the time of manufacture, siding meets or exceeds the performance standards set forth in ICC-ES AC321 and has achieved code recognition under ESR-1301, CCMC 11826-L, APA recognition under PR-N124, and HUD recognition under HUD-MR-1318c. For copies of Product Approvals go online at <https://lpcorp.com/resources/product-literature/> or call LP Customer Support at 888-820-0325.
- Minimum 6 inch (152 mm) clearance must be maintained between siding and finish grade (ground cover).
- Siding applied adjacent to surfaces such as porches, patios, balconies, walking surfaces or porch columns must have a clearance of at least 1 inch (25 mm) above any horizontal surface. Clearance may be reduced to 3/8 inch (10 mm) for:
 - Porches, patios, balconies, or walking surfaces that slope away from the structure and are covered by a roof, not an eave or overhang; or
 - Porch columns.
- Minimum 1 inch (25 mm) clearance at intersection with roof line.
- Apply siding in a manner that prevents moisture intrusion and water buildup.
- All wood substrate that is exposed to the weather must be sealed in a manner that prevents moisture intrusion and water build up.
 - Seal ALL exposed cuts of siding and trim. Field spray applied coatings on cuts are not recommended.
 - Sealing can be accomplished by applying a coating or sealant according to the manufacturer's requirements.
 - Butt joints that are covered with joint molding, sealant or factory prefinished end, are considered sealed from the weather.
- See Alternate Fastening Options for fastening lap siding to SIP, ICF and Steel Frame assemblies.
- **DO NOT USE STAPLES.**
- **SIDING MUST NOT BE IN DIRECT CONTACT WITH MASONRY, CONCRETE, BRICK, STONE, STUCCO OR MORTAR.**



Backcountry Tiny Homes, LLC
 26 Owens Court
 Suite 6
 Hampstead, NH 03841

LP SmartSide Details II

Model Type: Custom

Designer Name: Tina
 Client Name(s): Peggy
 Project Number: BTH0095-PL
 Draft: Shell Construction Plans
 Date: June 15, 2021

PANEL LAP DETAIL

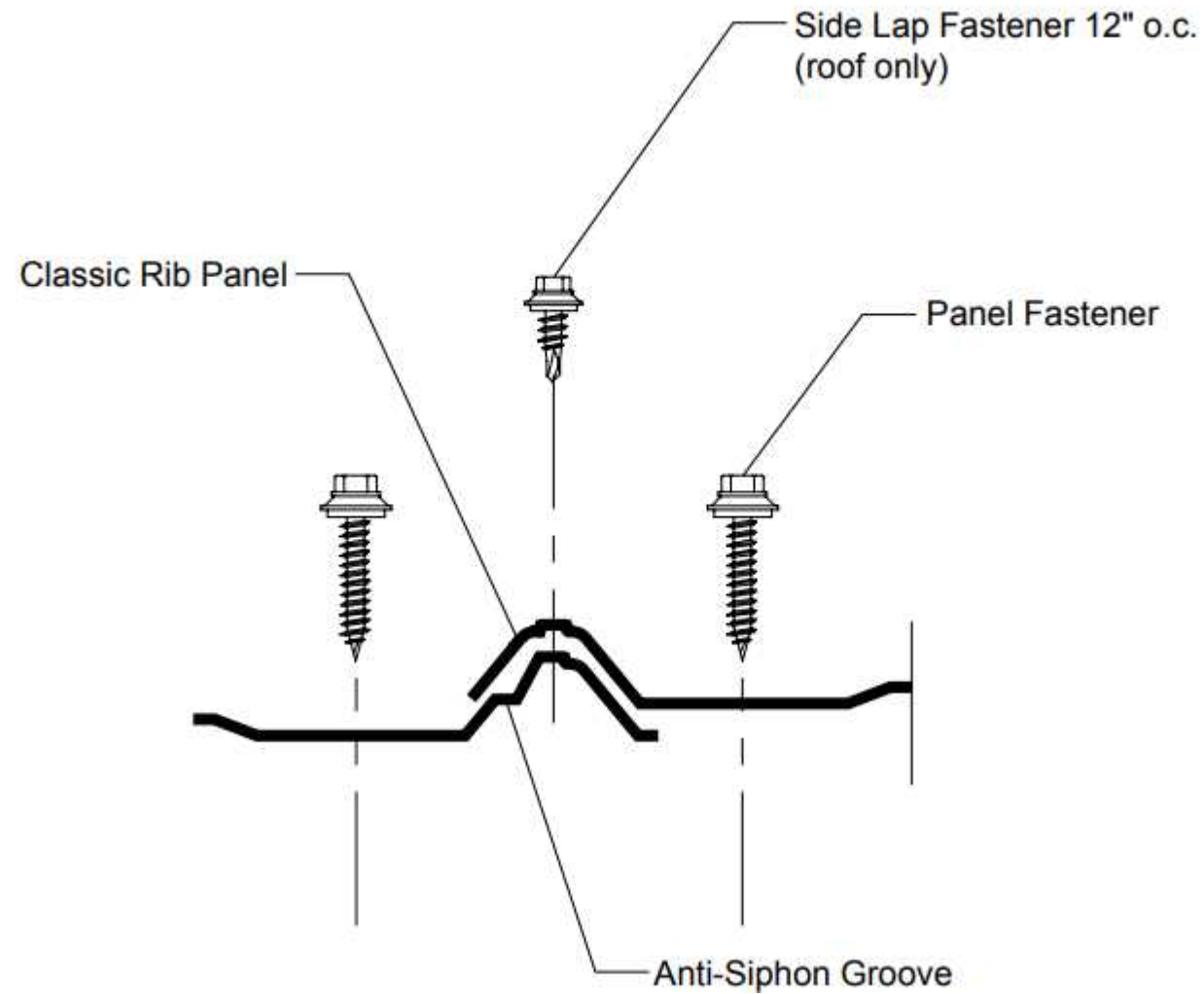

FASTENING PATTERNS

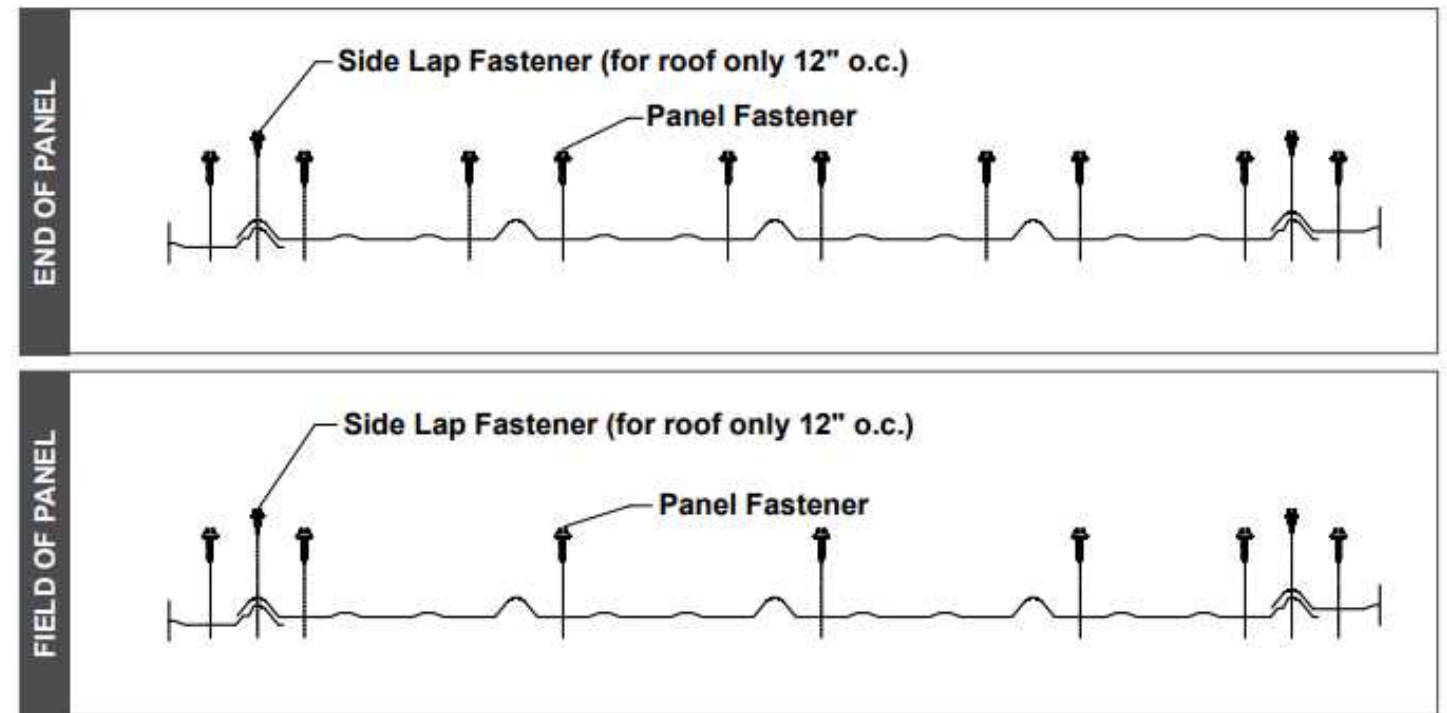

Backcountry Tiny Homes, LLC
26 Owens Court
Suite 6
Hampstead, NH 03841

Metal Roofing/Siding Details I

Model Type: Custom

Designer Name: Tina
Client Name(s): Peggy
Project Number: BTH0095-PL
Draft: Shell Construction Plans
Date: June 15, 2021

GABLE TRIM DETAIL

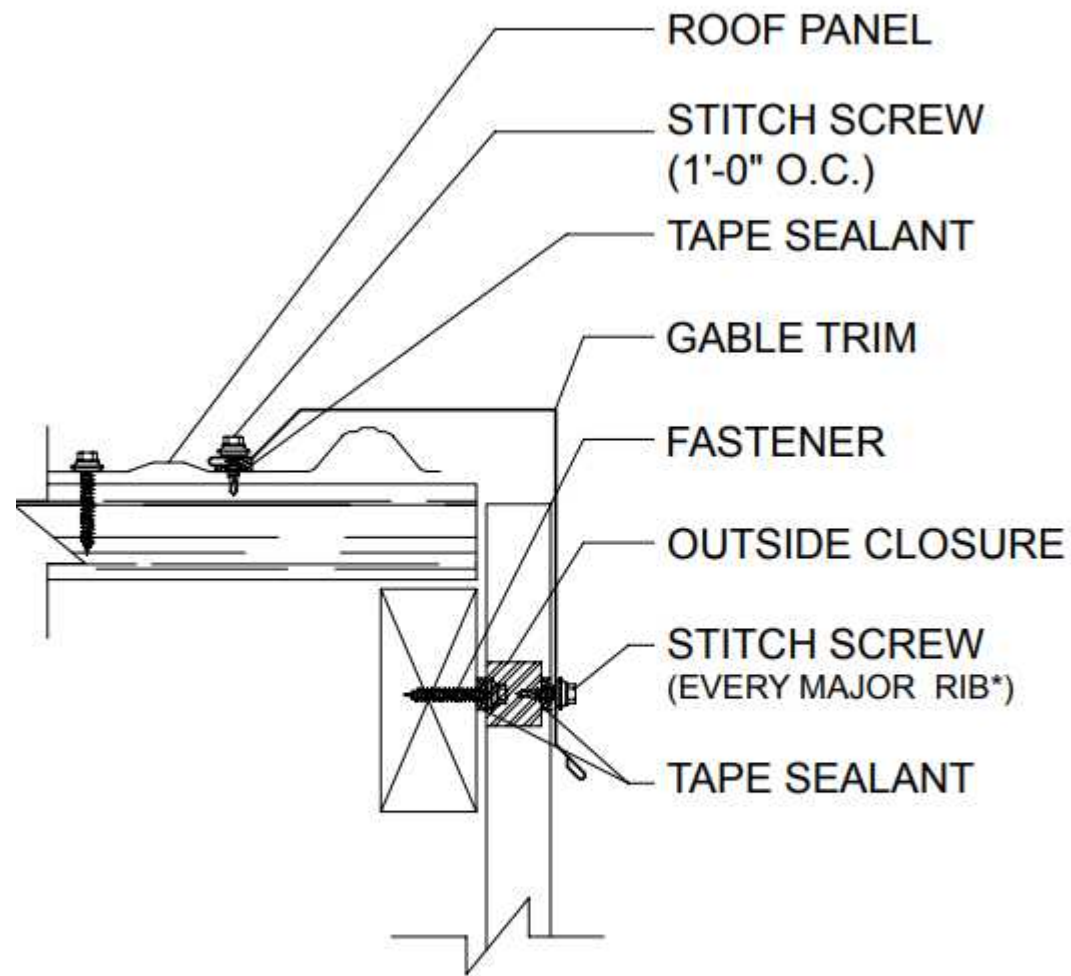

BTH Note: Use 12" O.C.

* Fastener to be 8"-12" O.C. depending on panel profile.

EAVE MOLDING DETAIL

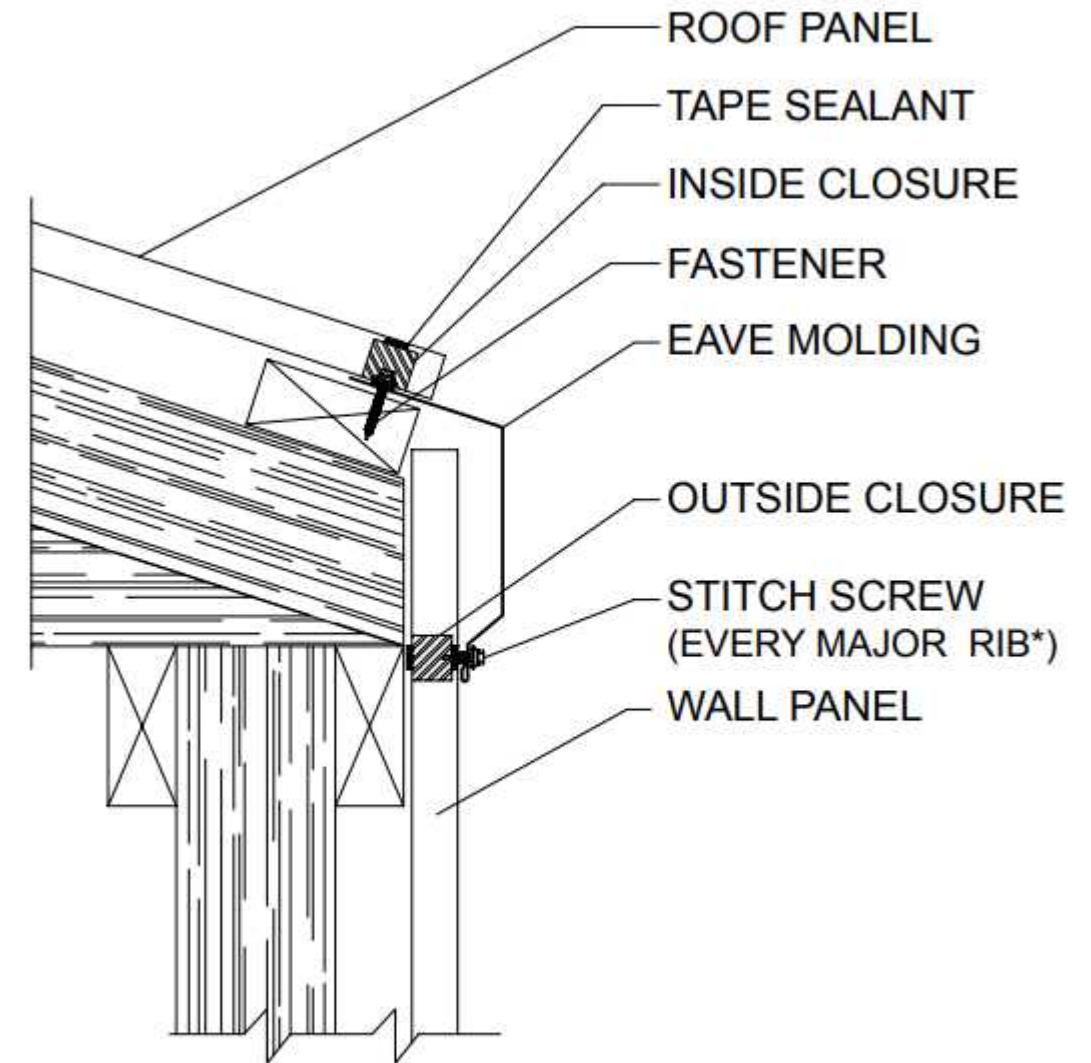

BTH Note: Use 12" O.C.

* Fastener to be 8"-12" O.C. depending on panel profile.



Backcountry Tiny Homes, LLC
 26 Owens Court
 Suite 6
 Hampstead, NH 03841

Metal Roofing/Siding Details II

Model Type: Custom

Designer Name: Tina
 Client Name(s): Peggy
 Project Number: BTH0095-PL
 Draft: Shell Construction Plans
 Date: June 15, 2021

OUTSIDE CORNER DETAIL

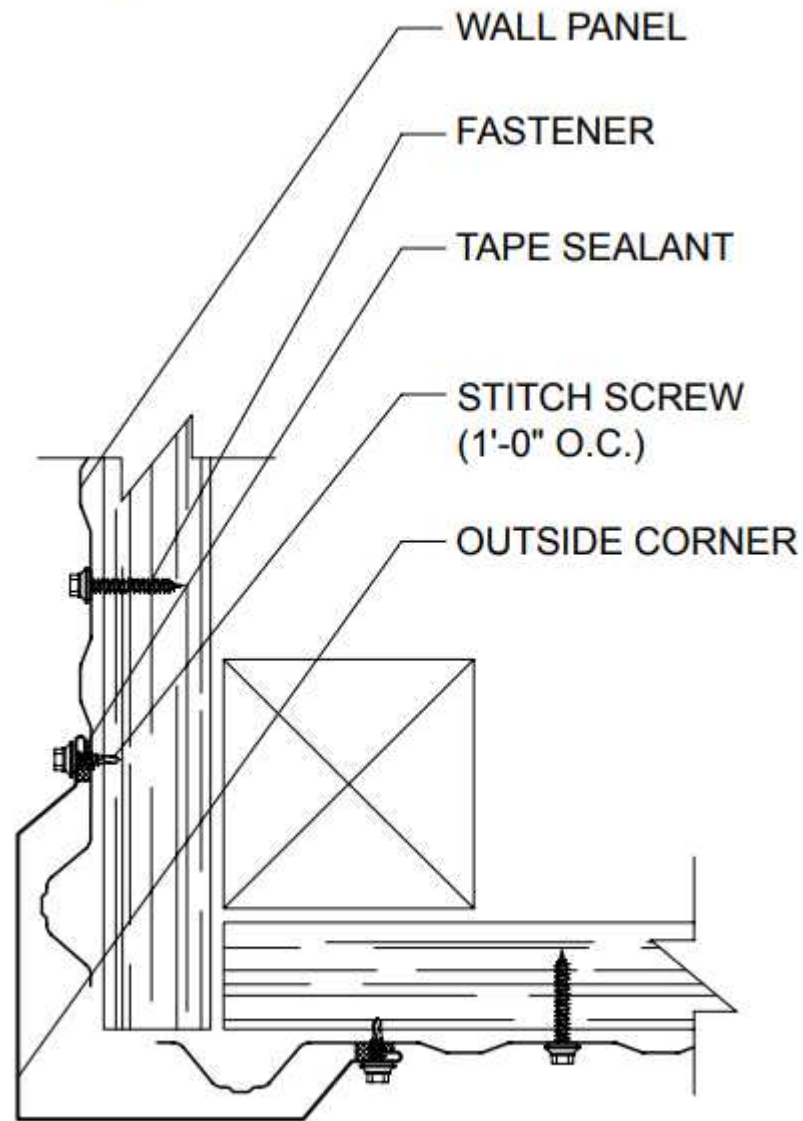

ANGLE BASE DETAIL

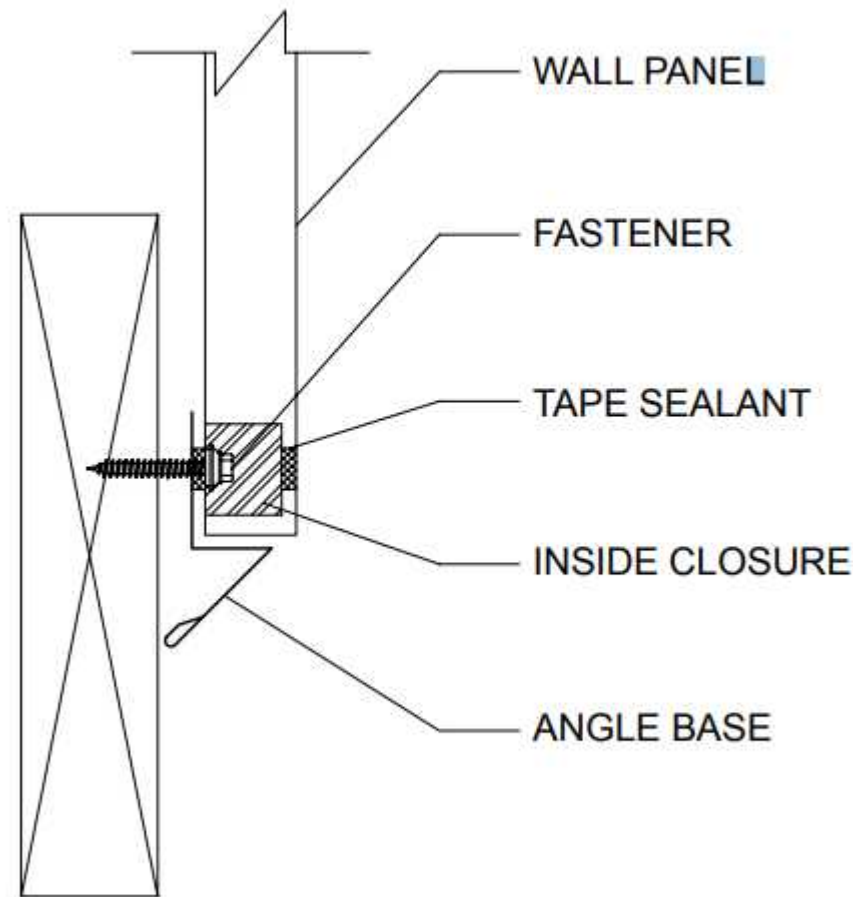

MINI-ANGLE / U-FLASHING DETAIL

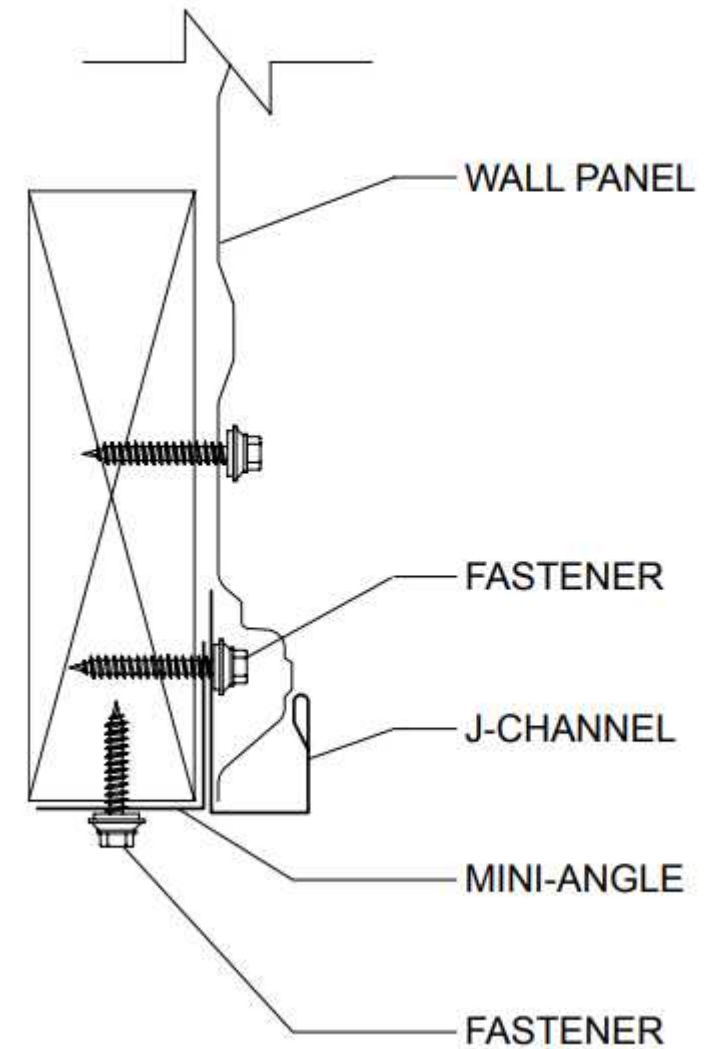

Backcountry Tiny Homes, LLC
 26 Owens Court
 Suite 6
 Hampstead, NH 03841

Metal Roofing/Siding Details III

Model Type: Custom

Designer Name: Tina
 Client Name(s): Peggy
 Project Number: BTH0095-PL
 Draft: Shell Construction Plans
 Date: June 15, 2021